

REVISIONS				
REV.	ECO. NO	DESCRIPTION	DATE	BY
A	1521	INITIAL RELEASE	10/3/2007	VJ
B	2147	ADD 47 & 50 POSITIONS	6/03/2010	JH
C	2259	ADD CONTACT GAP DIM .030", SIT DEPTH .020", UPDATE INSERTION/WITHDRAWAL FORCE, ADD DRS (OBSOLETE DWG #11519), S38, S81, S328 CONFIGURATIONS, UPDATE NOTE & DWG FORMAT	2/07/2011	JH
D	3585	ADD 49 POSITION, UPDATE DWG FORMAT, ADD 'T' MATERIAL CODE, ADDED TABLE 1 TO PRODUCTION DRAWING	12/14/2016	EP

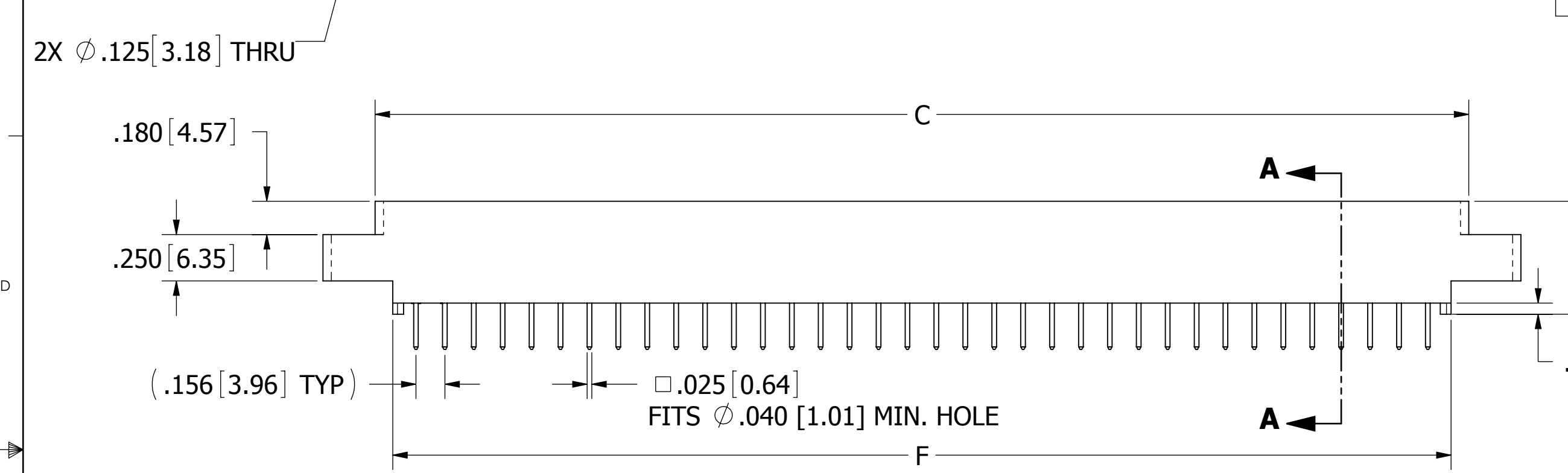

(.075 [1.91]  
CARD SLOT  
SEE NOTE 13)

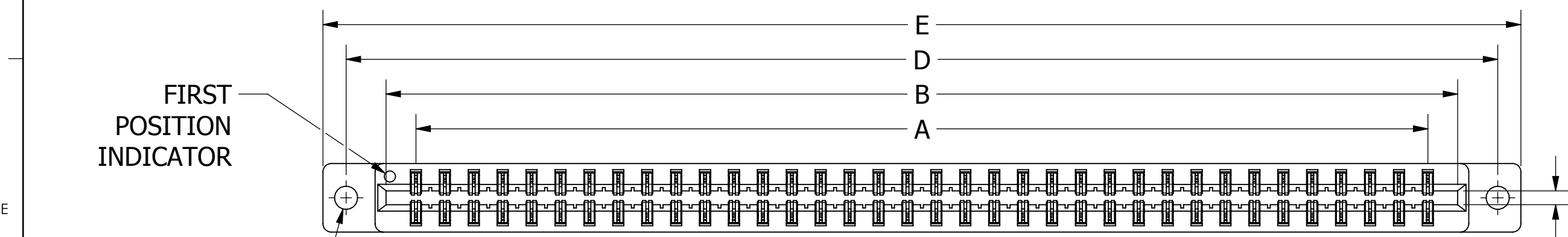
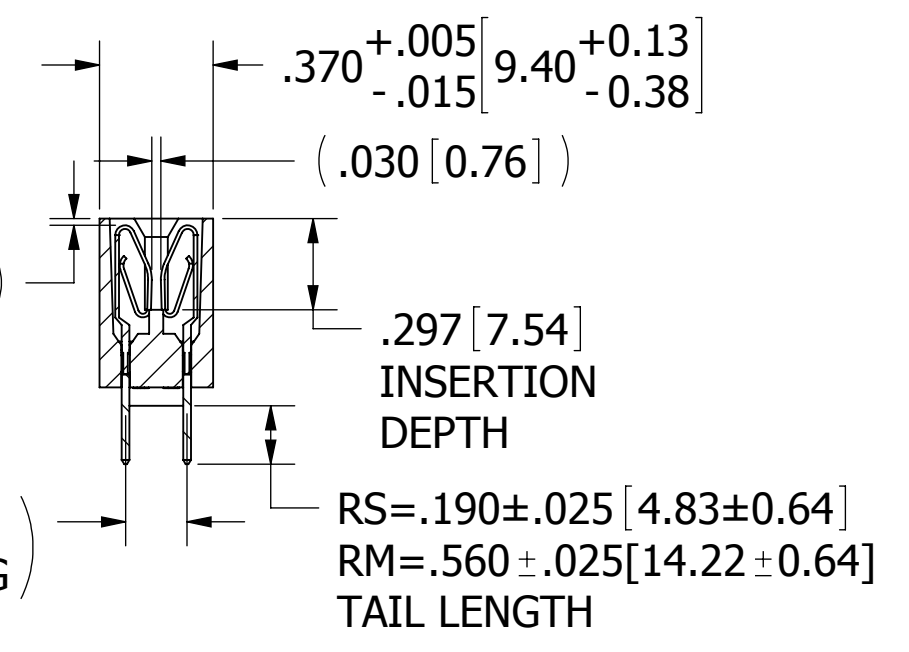

**SECTION A-A**  
**SCALE 2 : 1.25**

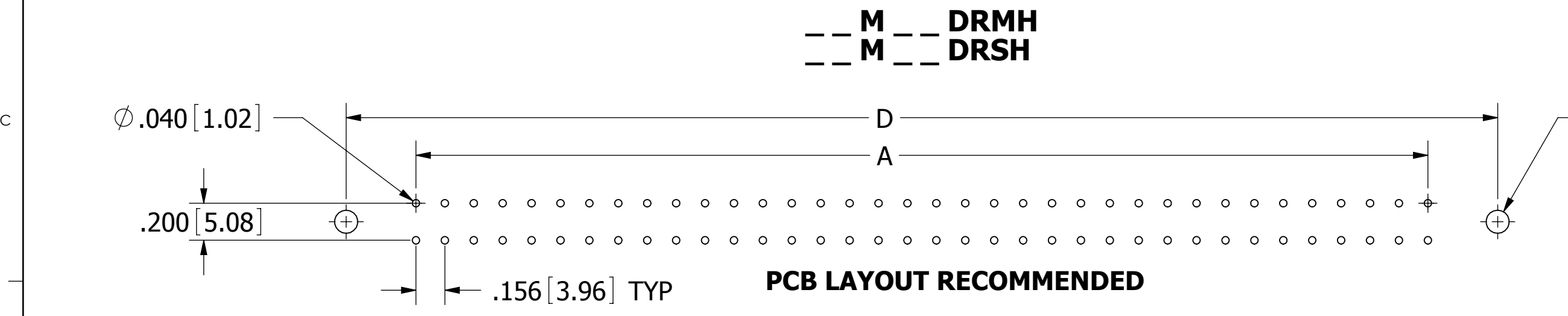

2X Ø.125 [3.18]  
FOR H, I, W, D, X  
OR T MOUNTING

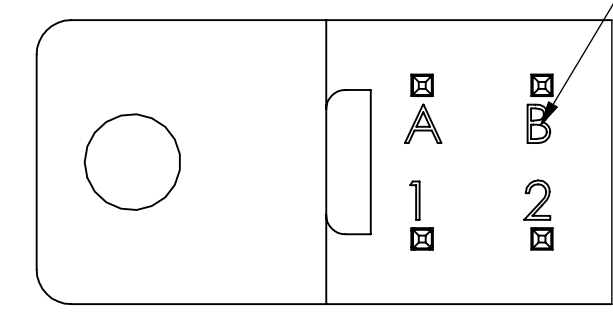

**CONTACT ID**  
**SCALE 4:1**

CONTACT MARKINGS  
(LETTERS G, I, O & Q NOT USED)

SIZES 06-25, 28, 30, & 31  
1 2 ... 23 24 ... 29 30  
A B ... A B ... H J

SIZES 36 - 43  
A B ... A B ... X Y  
1 2 ... 23 24 ... 42 43

SIZES 47, 49 & 50  
1 3 ... 97 99  
2 4 ... 98 100

- NOTES:**
1. INSULATOR MATERIAL: SEE PART NUMBER CODING
  2. CONTACT MATERIAL: SEE PART NUMBER CODING
  3. PLATING: SEE PART NUMBER CODING
  4. OPERATING TEMPERATURE: SEE PART NUMBER CODING
  5. PROCESSING TEMP: SEE PART NUMBER CODING
  6. UL FLAMMABILITY RATING: 94V-0
  7. OPERATING VOLTAGE: 950 VAC
  8. CURRENT RATING: 3 AMP
  9. CONTACT RESISTANCE: 30 MILLI OHMS MAX
  10. INSULATION RESISTANCE: 5000 MEGA OHMS
  11. DURABILITY: 500 CYCLES MINIMUM
  12. CONNECTOR IDENTIFICATION: THE PART SHALL BE MARKED WITH A PART NUMBER AND LOT CODE
  13. BOARD THICKNESS ACCOMMODATED: .062 ± .008 [1.57 ± 0.20]
  14. INSERTION FORCE: 8 OZ MAX PER CONTACT PAIR WHEN USING A .062 [1.57] TEST BLADE
  15. WITHDRAWAL FORCE: 1 OZ MIN PER CONTACT PAIR USING .062 [1.57] TEST BLADE
  16. MODIFICATION: SEE PART NUMBER CODING



UNLESS OTHERWISE SPECIFIED: DIMENSIONS ARE IN INCHES [MM]		DRAWN	DATE	NAME		
			10/3/07	VJ		
TOLERANCES: ANGULAR: ± 1° DECIMALS .XX = ± .02 [.5] .XXX = ± .005 [13] .XXXX = ± .0005 [013]		<small>THE INFORMATION HEREIN CONTAINS PROPRIETARY INFORMATION OF SULLINS ELECTRONICS AND IS NOT TO BE REPRODUCED, USED OR DISCLOSED TO OTHERS FOR ANY PURPOSE EXCEPT AS SPECIFICALLY AUTHORIZED IN WRITING BY AN OFFICER OF SULLINS ELECTRONICS.</small>			TITLE	EDGE CARD, .156 CC, HP
					PART NUMBER	__M__D(RS, RM) (-S38, -S81, -S328)
		SIZE	CAGE CODE	DWG. NO.	REV	
		C	54453	C10976	D	
		SCALE: 2:1		SHEET 1 OF 3		

**CUSTOMER COPY**

8 7 6 5 4 3 2 1

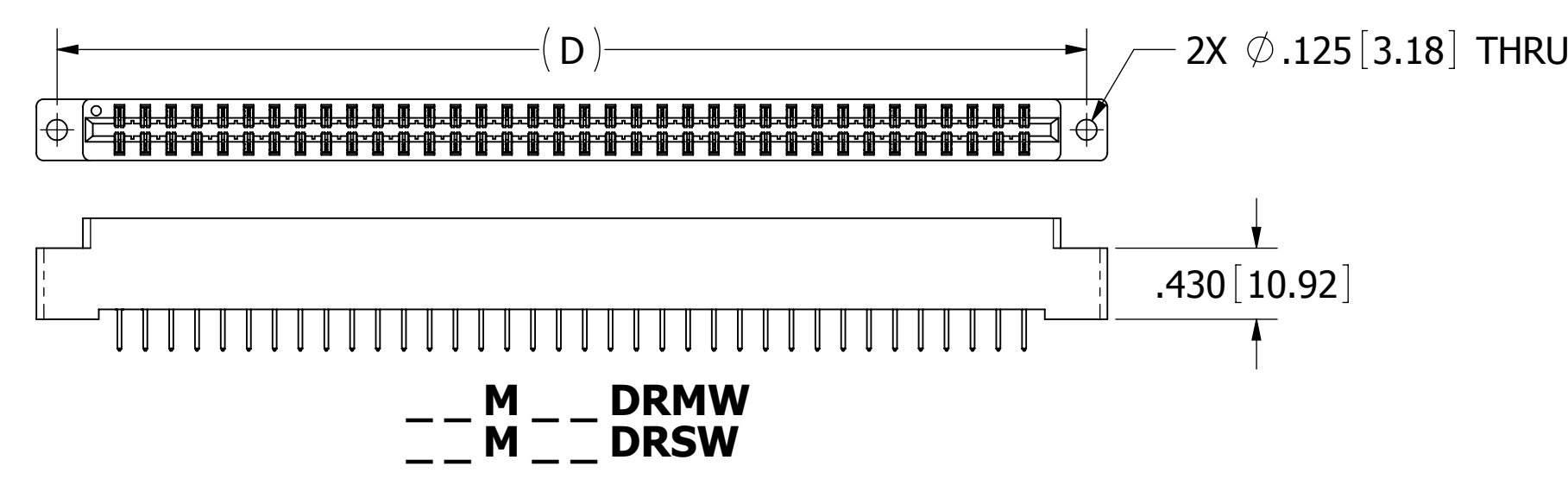
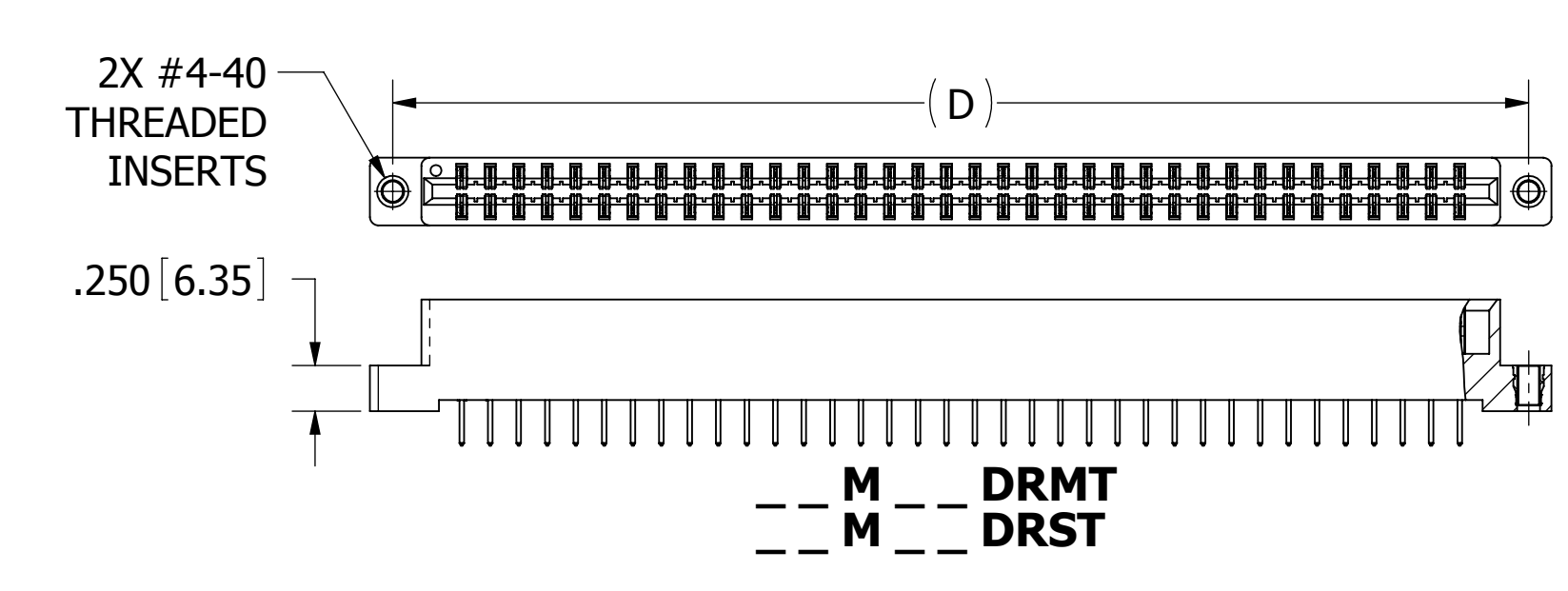
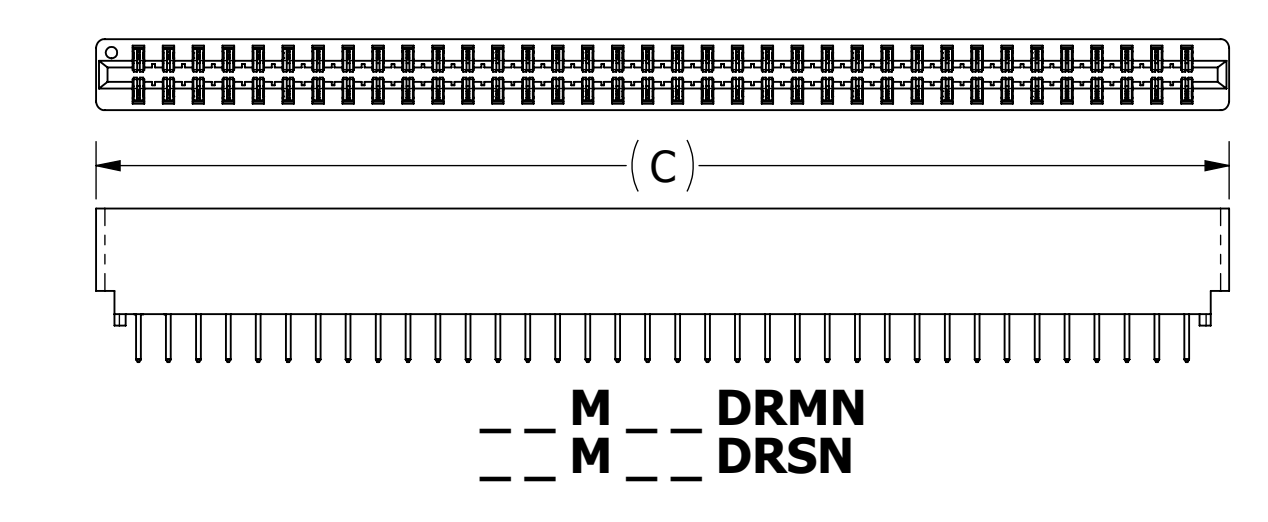
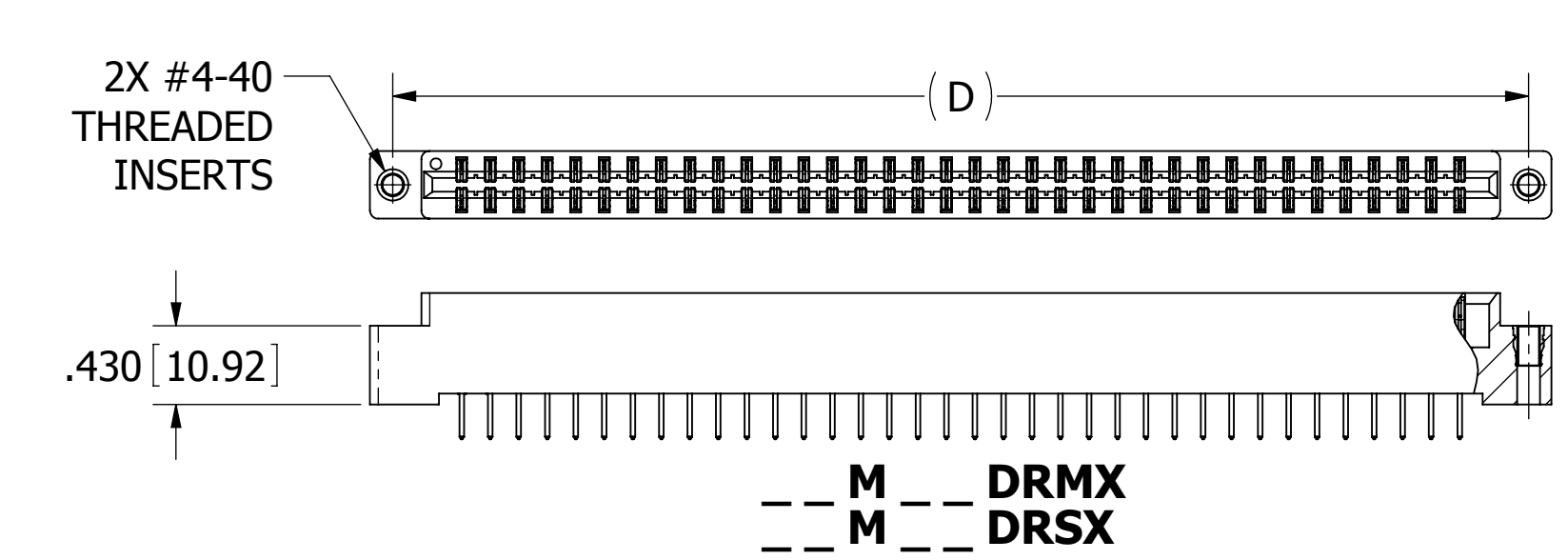
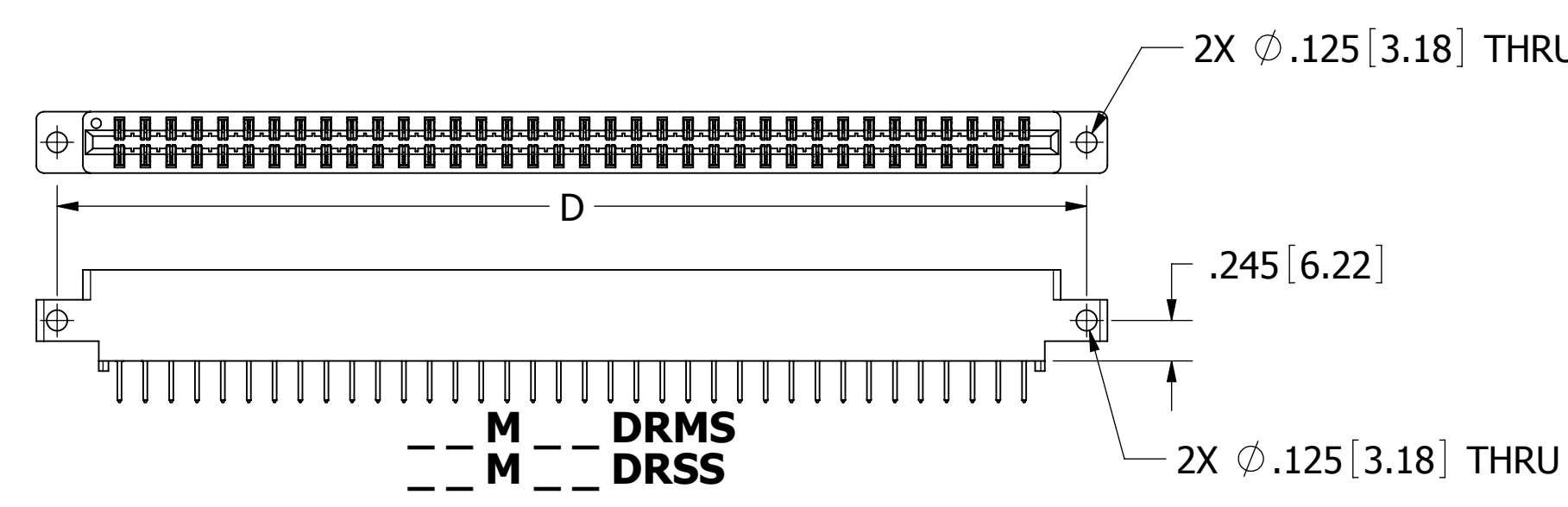
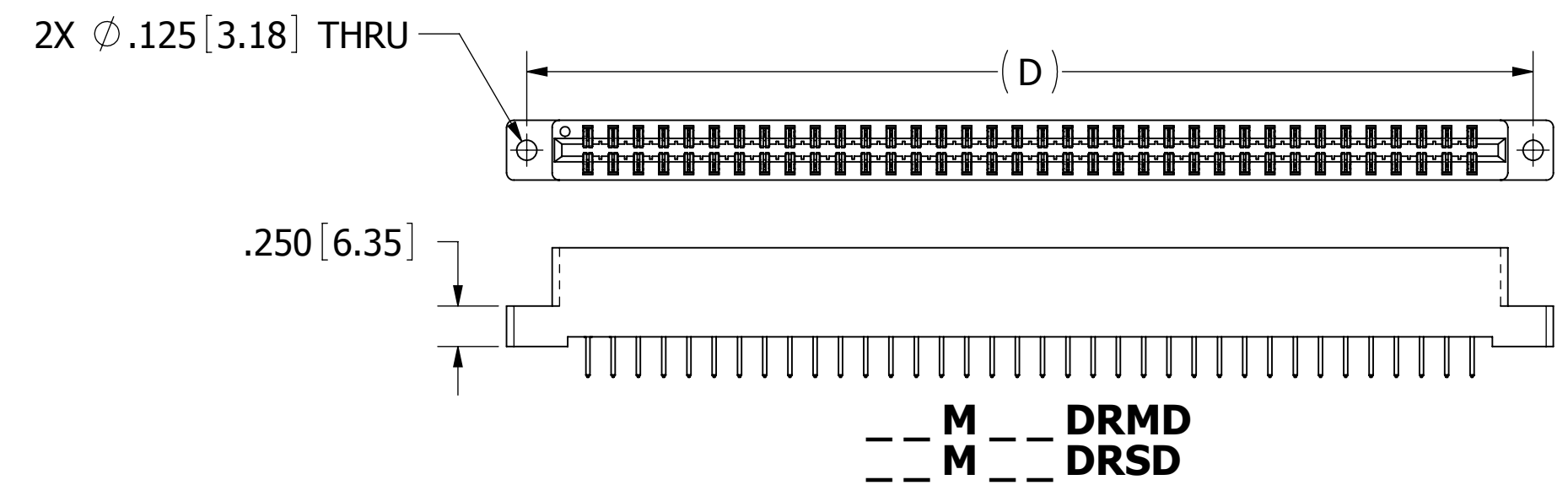
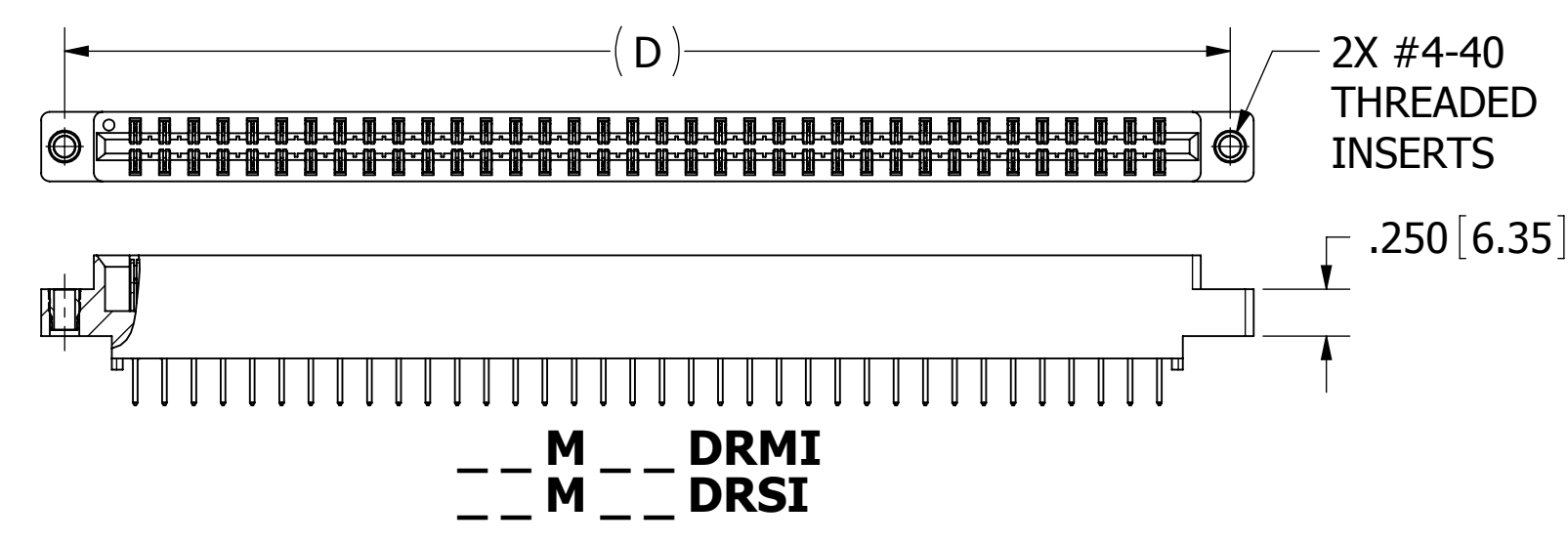

# CUSTOMER COPY



UNLESS OTHERWISE SPECIFIED: DIMENSIONS ARE IN INCHES [MM]		DRAWN	DATE	NAME	
<p>TOLERANCES:</p> <p>ANGULAR: ± 1°</p> <p>DECIMALS                  .XX = ± .02 [.5]                  .XXX = ± .005 [.13]                  .XXXX = ± .0005 [.013]</p>		10/3/07	VJ		
<p>THE INFORMATION HEREIN CONTAINS PROPRIETARY INFORMATION OF SULLINS ELECTRONICS AND IS NOT TO BE REPRODUCED, USED OR DISCLOSED TO OTHERS FOR ANY PURPOSE EXCEPT AS SPECIFICALLY AUTHORIZED IN WRITING BY AN OFFICER OF SULLINS ELECTRONICS.</p>					<p>TITLE EDGECARD, .156 CC, HP</p>
<p>PART NUMBER --- M --- D(RS, RM) (-S38, -S81, -S328)</p>					<p>SIZE C</p>
<p>SCALE: 1:1</p>		<p>CAGE CODE 54453</p>	<p>DWG. NO. C10976</p>	<p>REV D</p>	<p>SHEET 2 OF 3</p>

PART NUMBER	NO. OF POS.	INCHES						MILLIMETERS					
		A±.008	B±.008	C±.015	D±.010	E±.020	F±.015	A±0.20	B±0.20	C±0.38	D±0.25	E±0.51	F±0.38
_M06D(RS, RM)_	6	0.780	1.102	1.221	1.534	1.784	1.030	19.81	27.99	31.01	38.96	45.31	26.16
_M08D(RS, RM)_	8	1.092	1.414	1.533	1.846	2.096	1.342	27.74	35.92	38.94	46.89	53.24	34.09
_M10D(RS, RM)_	10	1.404	1.726	1.845	2.158	2.408	1.654	35.66	43.84	46.86	54.81	61.16	42.01
_M12D(RS, RM)_	12	1.716	2.038	2.157	2.470	2.720	1.966	43.59	51.77	54.79	62.74	69.09	49.94
_M15D(RS, RM)_	15	2.184	2.506	2.625	2.938	3.188	2.434	55.47	63.65	66.68	74.63	80.98	61.82
_M18D(RS, RM)_	18	2.652	2.974	3.093	3.406	3.656	2.902	67.36	75.54	78.56	86.51	92.86	73.71
_M20D(RS, RM)_	20	2.964	3.286	3.405	3.718	3.968	3.214	75.29	83.46	86.49	94.44	100.79	81.64
_M22D(RS, RM)_	22	3.276	3.598	3.717	4.030	4.280	3.526	83.21	91.39	94.41	102.36	108.71	89.56
_M24D(RS, RM)_	24	3.588	3.910	4.029	4.342	4.592	3.838	91.14	99.31	102.34	110.29	116.64	97.49
_M25D(RS, RM)_	25	3.744	4.066	4.185	4.498	4.748	3.994	95.10	103.28	106.30	114.25	120.60	101.45
_M28D(RS, RM)_	28	4.212	4.534	4.653	4.966	5.216	4.462	106.98	115.16	118.19	126.14	132.49	113.33
_M30D(RS, RM)_	30	4.524	4.846	4.965	5.278	5.528	4.774	114.91	123.09	126.11	134.06	140.41	121.26
_M31D(RS, RM)_	31	4.680	5.002	5.121	5.434	5.684	4.930	118.87	127.05	130.07	138.02	144.37	125.22
_M36D(RS, RM)_	36	5.460	5.782	5.901	6.214	6.464	5.710	138.68	146.86	149.89	157.84	164.19	145.03
_M40D(RS, RM)_	40	6.084	6.406	6.525	6.838	7.088	6.334	154.53	162.71	165.74	173.69	180.04	160.88
_M43D(RS, RM)_	43	6.552	6.874	6.993	7.306	7.556	6.802	166.42	174.60	177.62	185.57	191.92	172.77
_M47D(RS, RM)_	47	7.176	7.498	7.617	7.930	8.180	7.426	182.27	190.45	193.47	201.42	207.77	188.62
_M49D(RS, RM)_	49	7.488	7.810	7.929	8.242	8.492	7.738	190.20	198.37	201.40	209.35	215.70	196.55
_M50D(RS, RM)_	50	7.644	7.966	8.085	8.398	8.648	7.894	194.16	202.34	205.36	213.31	219.66	200.51

**PART NUMBER CODING**

**M** **D** **S**

**MATERIALS (INSULATOR / CONTACT)**

- E = BLUE PBT/PHOSPHOR BRONZE**  
OPERATING TEMP: -65°C TO +125°C  
PROCESSING TEMP: WAVE/MANUAL SOLDERING
- R = GREEN PPS/PHOSPHOR BRONZE**  
OPERATING TEMP: -65°C TO +125°C  
PROCESSING TEMP: 260°C MAX FOR 20 SECS
- G = BLACK PA9T/PHOSPHOR BRONZE**  
OPERATING TEMP: -65°C TO +125°C  
PROCESSING TEMP: 260°C MAX FOR 20 SECS
- A = GREEN PPS/BERYLLIUM COPPER**  
OPERATING TEMP: -65°C TO +150°C  
PROCESSING TEMP: 260°C MAX FOR 20 SECS
- J = BLACK PA9T/BERYLLIUM COPPER**  
OPERATING TEMP: -65°C TO +150°C  
PROCESSING TEMP: 260°C MAX FOR 20 SECS
- T = GREEN PPS/BERYLLIUM COPPER**  
OPERATING TEMP: -65°C TO +175°C  
PROCESSING TEMP: 260°C MAX FOR 20 SECS

**MODIFICATION CODE**

- OMIT FOR STANDARD, EX: EBM22DRSN
- S38 = BLACK PBT (MATERIAL CODE E ONLY)
- S81 = GREEN PBT (MATERIAL CODE E ONLY)
- S328 = BROWN PPS (MATERIAL CODE R AND A ONLY)

**MOUNTING STYLE**

- H = .125" DIAMETER CLEARANCE HOLES
- I = #4-40 THREADED INSERT
- S = .125" DIAMETER SIDE MOUNTING
- N = NO MOUNTING EARS
- W = .430" EARS, FLUSH MOUNTING, .125" DIAMETER
- D = .250" EARS, FLUSH MOUNTING, .125" DIAMETER
- X = .430" EARS, FLUSH MOUNTING WITH # 4-40 THREADED INSERT
- T = .250" EARS, FLUSH MOUNTING WITH # 4-40 THREADED INSERT

**TERMINATION TYPE**

- RS = .190" TAIL LENGTH
- RM = .560" TAIL LENGTH  
(SEE SECTION A-A ON SHT1)

**NUMBER OF POSITIONS (CONTACTS PER ROW)**

**PLATING**

ALL PLATINGS ARE LEAD FREE AND HAVE .000050" NICKEL UNDERPLATE

**CONTACT SURFACE**

- B = .000010" GOLD
- C = .000030" GOLD
- G = .000010 GOLD
- Y = .000030" GOLD
- S = .000010" GOLD
- M = .000030" GOLD
- E = .000100" PURE TIN, MATTE

**TERMINATION**

- .000100" PURE TIN, MATTE
- .000100" PURE TIN, MATTE
- .000005" GOLD
- .000005" GOLD
- .000010" GOLD OVERALL
- .000010" GOLD OVERALL
- .000100" PURE TIN, MATTE, OVERALL

OVERALL PURE TIN ONLY AVAILABLE ON MATERIAL CODES E, R AND G

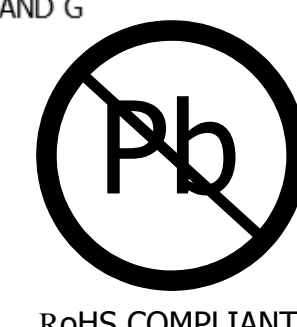
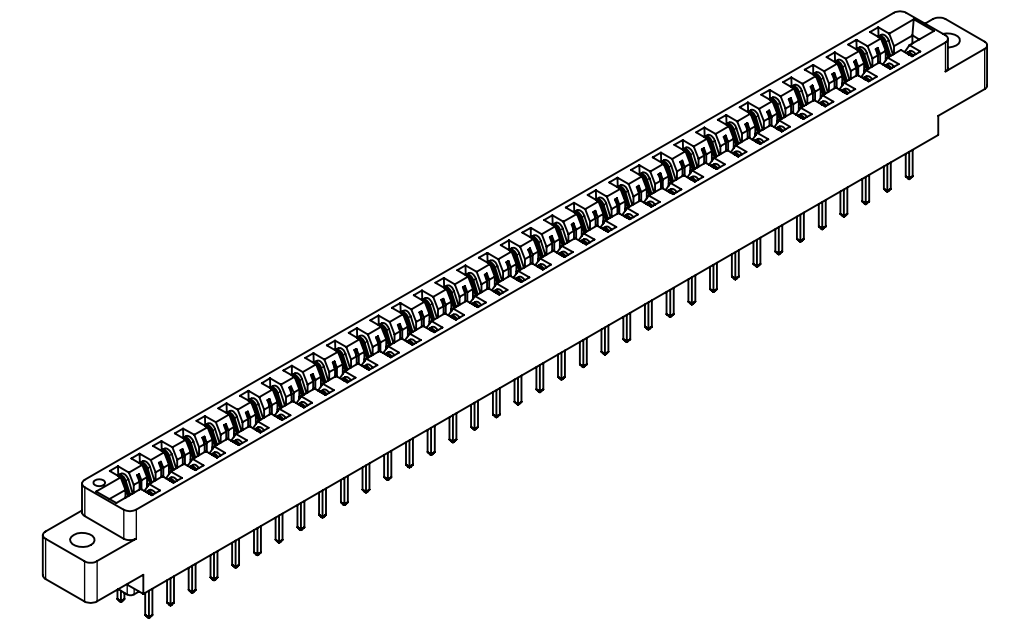

**CUSTOMER COPY**

UNLESS OTHERWISE SPECIFIED: DIMENSIONS ARE IN INCHES [MM]		DRAWN	DATE	NAME		
			10/3/07	VJ		
TOLERANCES:					<small>THE INFORMATION HEREIN CONTAINS PROPRIETARY INFORMATION OF SULLINS ELECTRONICS AND IS NOT TO BE REPRODUCED, USED OR DISCLOSED TO OTHERS FOR ANY PURPOSE EXCEPT AS SPECIFICALLY AUTHORIZED IN WRITING BY AN OFFICER OF SULLINS ELECTRONICS.</small>	
ANGULAR: ± 1°					TITLE EDGE CARD, .156 CC, HP	
DECIMALS .XX = ± .02 [.5] .XXX = ± .005 [.13] .XXXX = ± .0005 [.013]					PART NUMBER _M_D(RS, RM)_ (-S38, -S81, -S328)	
SCALE: 2:1		SIZE	CAGE CODE	DWG. NO.	REV	
		C	54453	C10976	D	
					SHEET 3 OF 3	