

RECOMMENDED PCB LAYOUT  
 TOLERANCE IS ±0.05

REVISIONS				
P	LTR	DESCRIPTION	DATE	APVD
D		REVISED PER ECO-18-008015	24MAY2018	AP DG

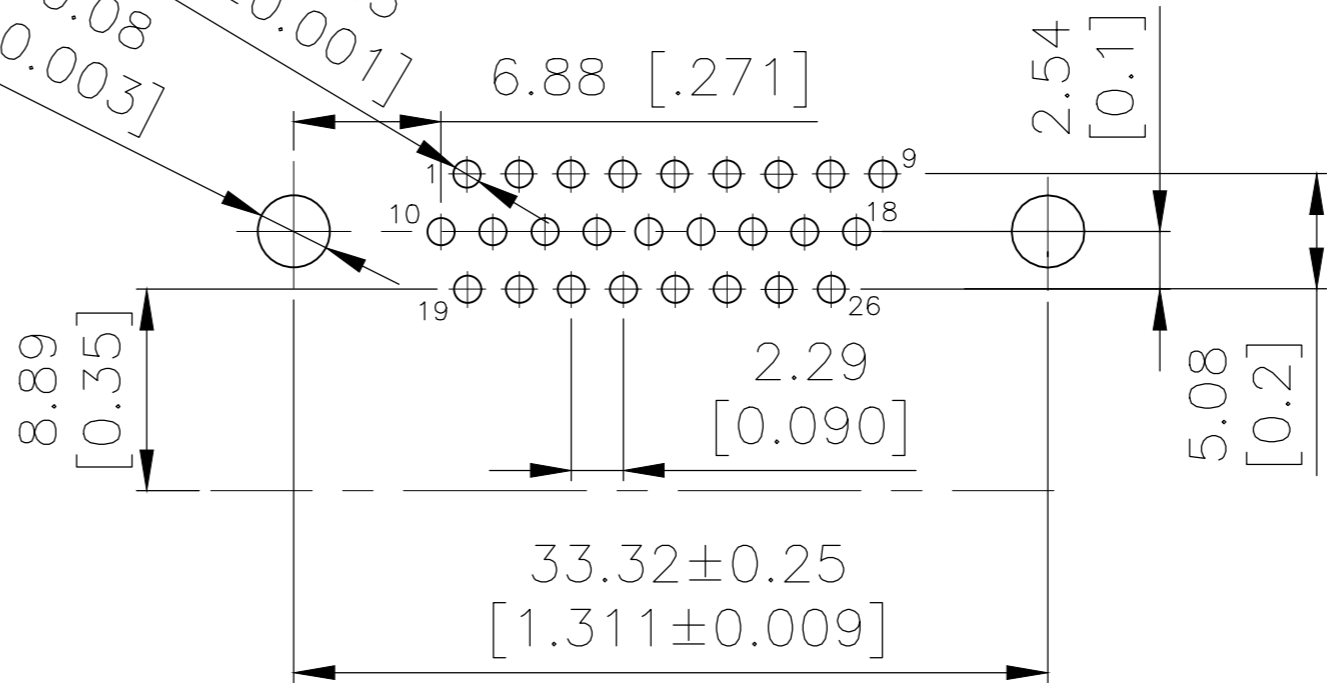

NOTES:  
 Housing:PBT+30%GF(UL94V-0) BLACK  
 Contact:Brass  
 " GOLD PLATING ON CONTACT AREA  
 100u" MATTE TIN PLATING ON SOLDER TAIL  
 50u" NICKEL UNDERPLATED OVERALL  
 Holddown:Brass,100u" TIN OVER 50u" NICKEL  
 Shell: Cold Roller Steel, Ni Plated  
 Revit:Brass,Nickel Plating  
 LOT NUMBER "XXXX"  
 └── Stands For Calendar Year  
 └── Stands For Week Number

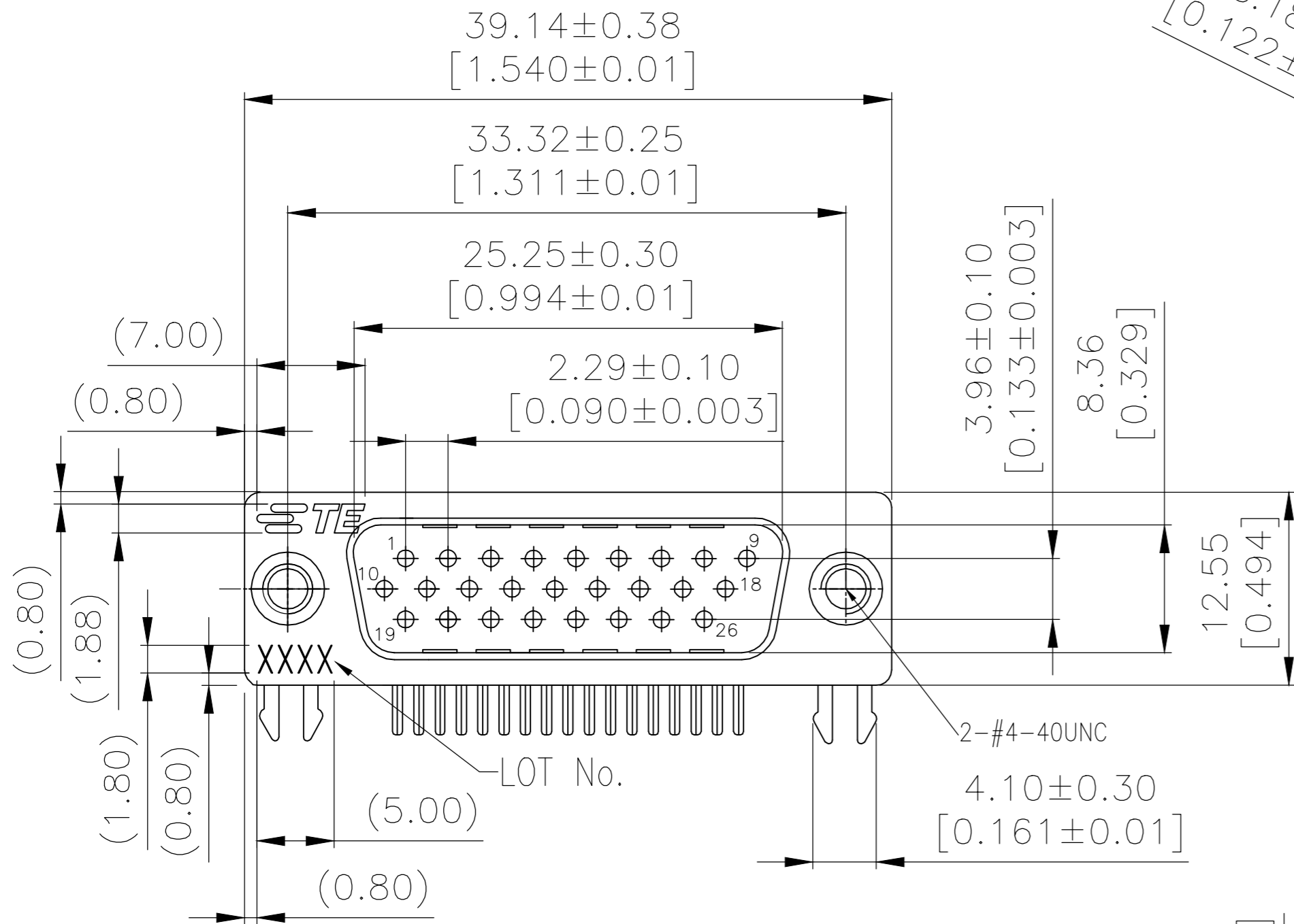
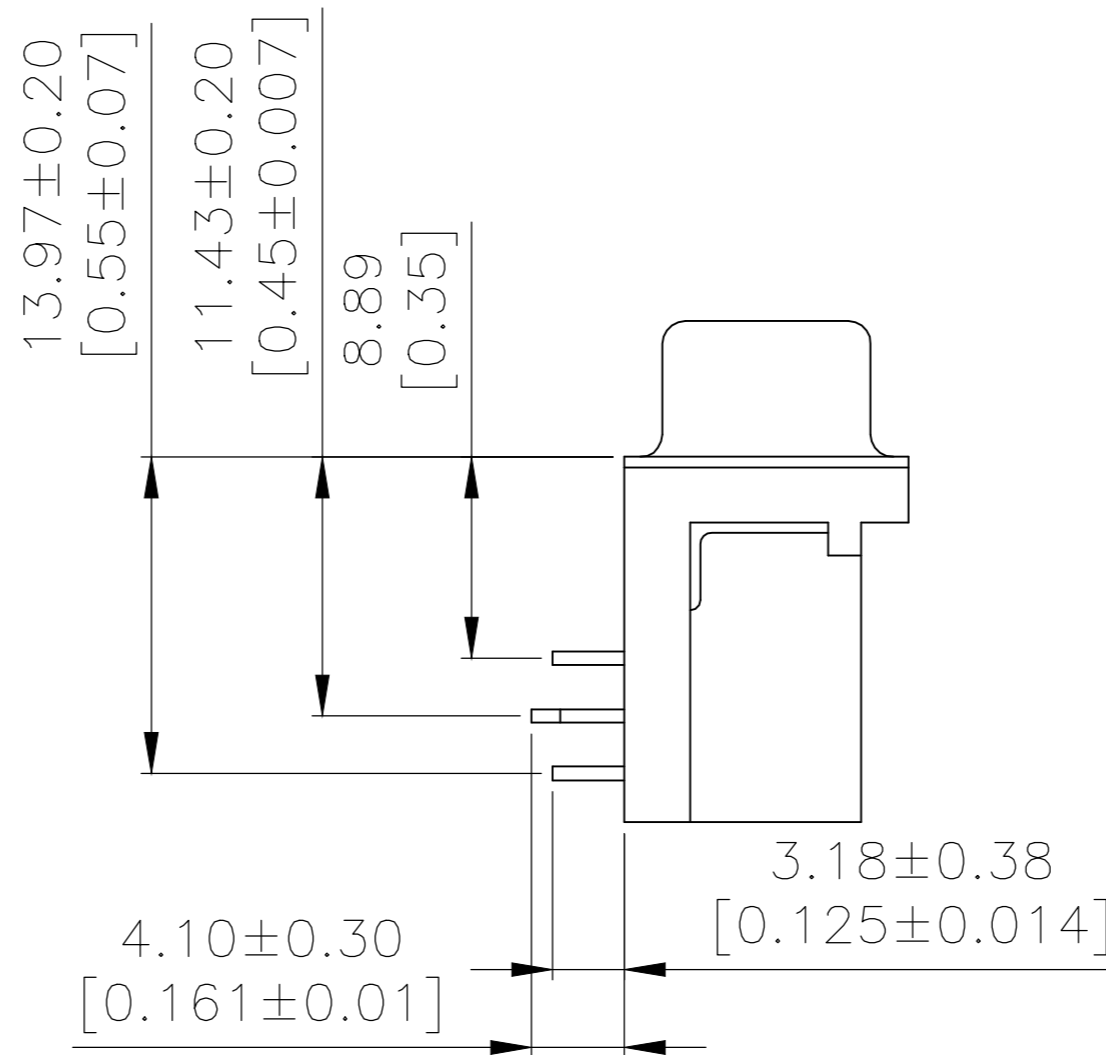
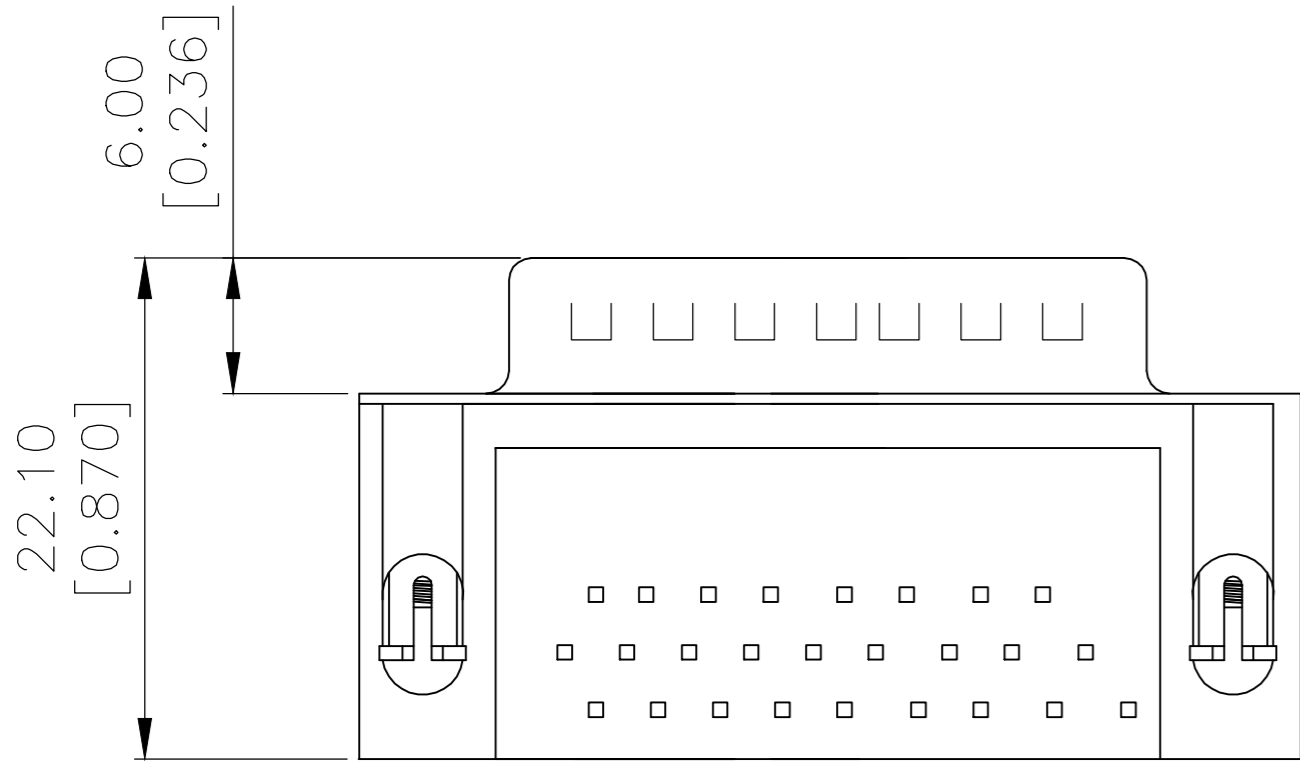

THREADED TYPE	30μ" Au Contact Area Plating	2311776-1 P/N
---------------	------------------------------	---------------

THIS DRAWING IS A CONTROLLED DOCUMENT.		DWN AJITH PAI 25FEB2017	<b>STE</b> TE Connectivity	
DIMENSIONS: mm		CHK DANIEL GORENC 25FEB2017		
TOLERANCES UNLESS OTHERWISE SPECIFIED:		APVD DANIEL GORENC 25FEB2017	NAME AMPLIMITE PLUG, HD22, RIGHT ANGLE, 26P THREADED	
0 PLC ± -		PRODUCT SPEC 108-130023	SIZE A2	
1 PLC ± -		APPLICATION SPEC	CAGE CODE 00779	
2 PLC ± 0.25			DRAWING NO C=2311776	
3 PLC ± -			RESTRICTED TO	
4 PLC ± -			-	
ANGLES ± -			SCALE 1:1	
FINISH			SHEET 1 of 1	
MATERIAL			REV D	
			CUSTOMER DRAWING	