

THIS DRAWING IS UNPUBLISHED. RELEASED FOR PUBLICATION, 19 .
 © COPYRIGHT 19 BY AMP INCORPORATED. ALL INTERNATIONAL RIGHTS RESERVED.

LOC	DIST	P	F	REVISIONS				
				ZONE	LTR	DESCRIPTION	DATE	APPD
AG	1				V	REACT-9; PER 0650-0052-98	5-6-98	LM

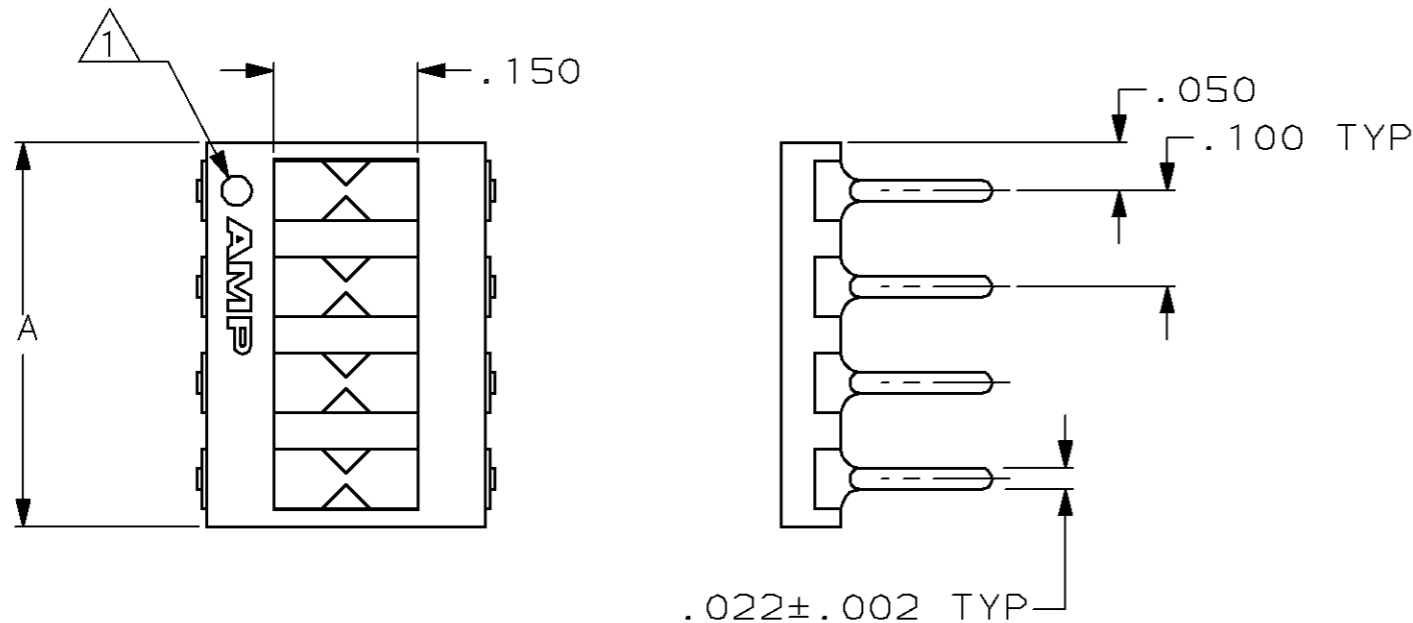

① PIN NUMBER ONE IDENTIFICATION.
 ② MOUNTING SURFACE WHEN INSERTED IN .040 DIA MOUNTING HOLES.

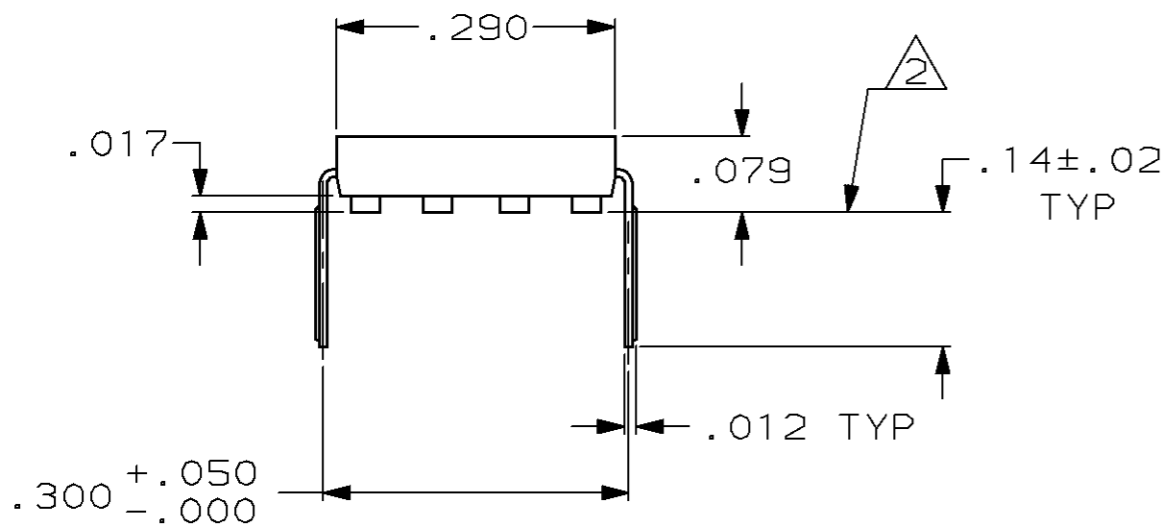

	.000015 MIN GOLD ON CONTACT LEADS, OVER NICKEL.			
OBSOLETE		.400	4	1-435704-6
OBSOLETE		.800	8	1-435704-4
	.000100 MIN. TIN OVER NICKEL	1.200	12	1-435704-2
		1.000	10	1-435704-0
		.900	9	435704-9
		.800	8	435704-8
		.700	7	435704-7
		.600	6	435704-6
OBSOLETE		.500	5	435704-5
		.400	4	435704-4
OBSOLETE		.300	3	435704-3
OBSOLETE		.200	2	435704-2

PLATING		A	NO. OF POSN	PART NO
DO NOT SCALE PRINT. UNLESS SPECIFIED DIMENSIONS TOLERANCES ON: 2 PLC DEC ± - 3 PLC DEC ± .005 ANGLES ± -	DR 12 OCT 1989 M.CYRUS	AMP AMP INCORPORATED Harrisburg, Pa. 17105 NAME SHUNT, DIP, PROGRAMMABLE 7600 SERIES		
MATERIAL HOUSING: BLACK POLYESTER CONTACT: COPPER ALLOY	CHK - APPD - APPD - PRODUCT SPEC -			
FINISH SEE TABLE	APPLICATION SPEC - WEIGHT -	SCALE 5:1	SHEET 1 OF 1	