

WRAPOST RECEPTACLES

FOR 0,81 - 1,17 DIAMETER PINS

1052/1053

105X-X-17-XX-34-XX-02-0

Press-fit in 2,11 mounting hole

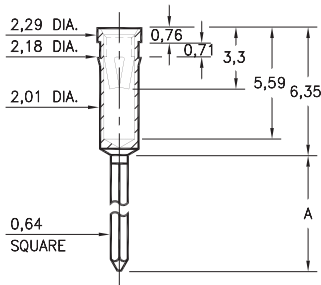

Basic Part Number	# of Wraps	Length A
1053-2	2	9,14
1052-3	3	13,08

0383

0383-X-17-XX-34-XX-02-0

Swage mount in 2,39 hole

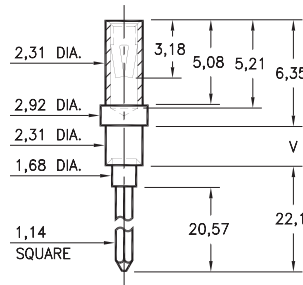

Basic Part Number	Board Thickness	Length V
0383-1	1,57	2,39
0383-2	2,39	3,18
0383-3	3,18	3,96

0382

0382-3-17-XX-34-XX-02-0

Press-fit in 2,26 mounting hole

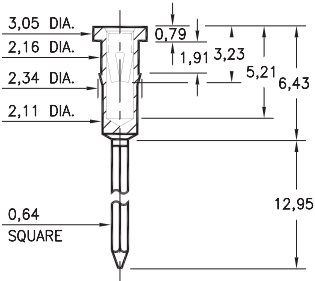

SPECIFICATIONS:

Shell Material: Brass Alloy 360, 1/2 Hard

Contact Material: Beryllium Copper Alloy 172, HT

Dimensions: Millimeters

Tolerances On: Lengths: ± 0,13

Diameters: ± 0,051

Angles: ± 2°



ORDER CODE: XXXX - X - 17 - XX - 34 - XX - 02 - 0

BASIC PART #

SPECIFY SHELL FINISH:

- 01 5,08µm TIN/LEAD OVER NICKEL
- ◆ 80 5,08µm TIN OVER NICKEL (RoHS)
- ◆ 15 0,25µm GOLD OVER NICKEL (RoHS)

SPECIFY CONTACT FINISH:

- 01 5,08µm TIN/LEAD OVER NICKEL
- ◆ 80 5,08µm TIN OVER NICKEL (RoHS)
- ◆ 27 0,76µm GOLD OVER NICKEL (RoHS)

SELECT CONTACT:

#34 CONTACT (DATA ON PAGE 258)

(For alternate contact choices, see group E on page 248)

