

LOC	DIST	REVISIONS			
		REV	BY	DATE	APPROV
HM	00	E		23JAN2013	JM S.J

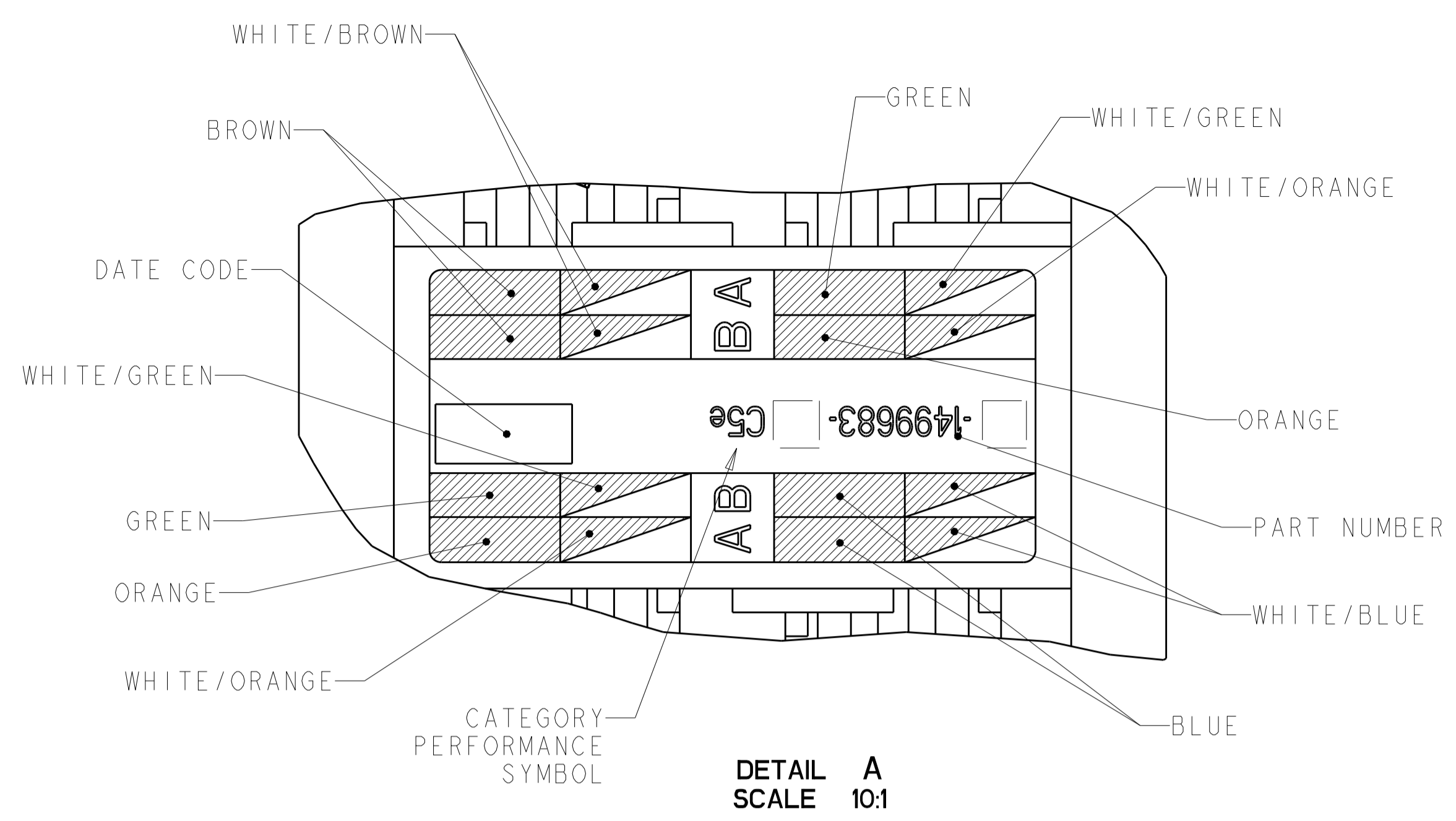

DETAIL A
SCALE 10:1

- 1. MATERIAL: JACK HOUSING - POLYCARBONATE, 94V-0 RATED. 110 BLOCK AND STRAIN RELIEF- POLYCARBONATE. ARRAY TRAY - PBT POLYESTER. JACK CONTACTS ARRAY - BERYLLIUM COPPER, PLATED WITH 1.27µm [.000050] MINIMUM THICK GOLD IN LOCALIZED AREA AND 3.81µm [.000150] MINIMUM THICK MATTE TIN IN BOARD INTERFACE AREA OVER 1.27µm [.000050] MINIMUM THICK NICKEL UNDERPLATE. IDC TERMINALS - PHOSPHOROUS BRONZE, PLATED WITH 3.81µm [.00015] MINIMUM THICK MATTE TIN OVER 1.27µm [.00005] MINIMUM THICK NICKEL UNDERPLATE.
- 2. KLS JACK WILL TERMINATE 22-24 AWG SOLID CONDUCTORS, 1.27(.050) MAXIMUM INSULATION DIAMETER. JACK WILL ACCEPT CONDUCTORS UP TO 1.45 (.057) BUT REQUIRE THE USE OF A STRAIN RELIEF.
- 3. CAVITY CONFORMS TO FCC RULES AND REGULATIONS PART 68 SUBPART F REQUIREMENTS.
- 4. ONE MODULAR JACK ASSEMBLY AND ONE STRAIN RELIEF PER POLYBAG. USE OF STRAIN RELIEF IS OPTIONAL.
- 5. USE IS OPTIONAL.
- 6. REFER TO 408-8858 FOR TERMINATION INSTRUCTIONS USING SL SERIES TOOL TERMINATION. REFER TO 408-8417 FOR TERMINATION INSTRUCTIONS USING 110 PUNCH DOWN TOOL.
- 7. KLS SERIES JACKS ARE COMPATIBLE WITH COMMSCOPE SYSTMIX (R) M-SERIES FACEPLATES.

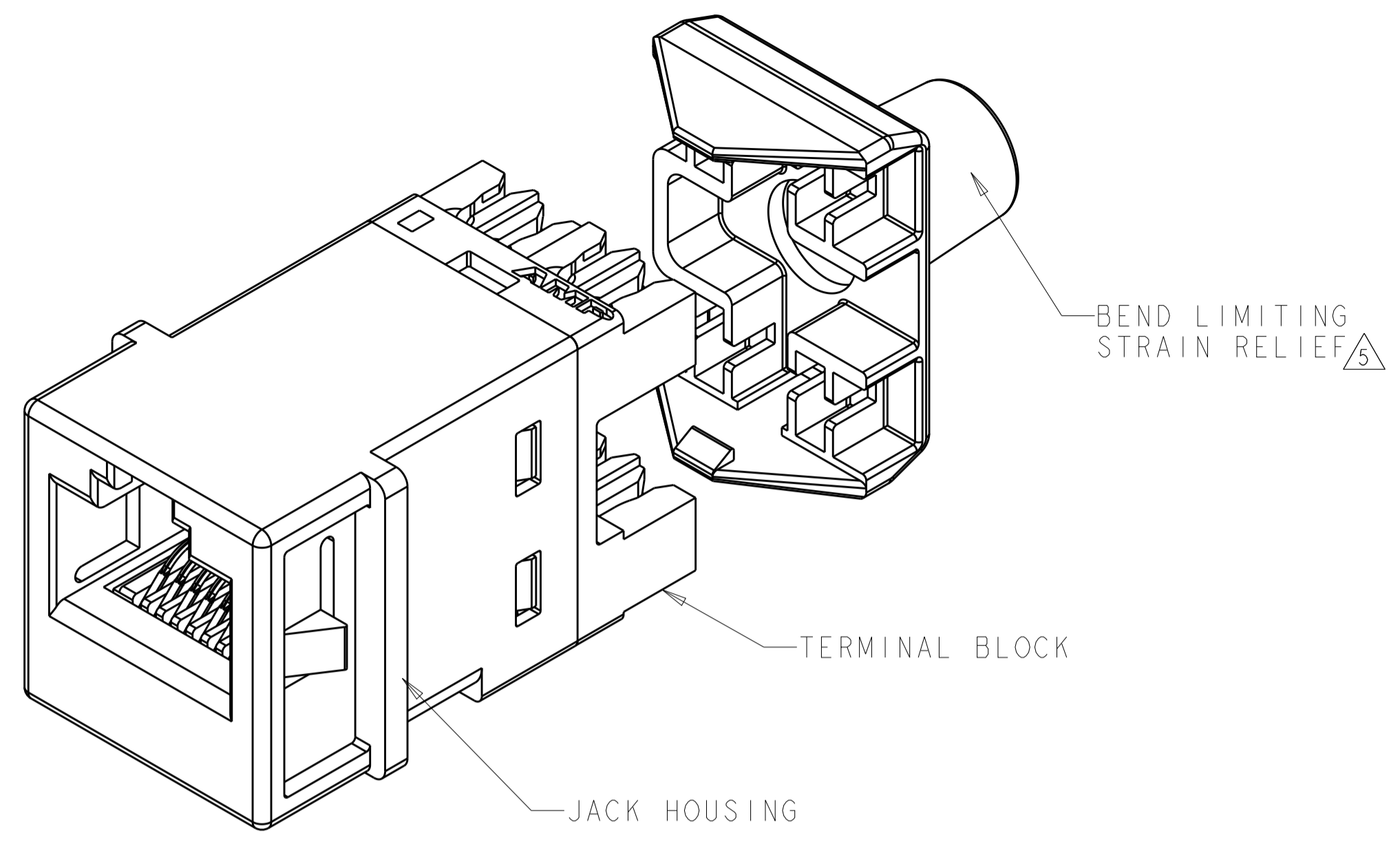
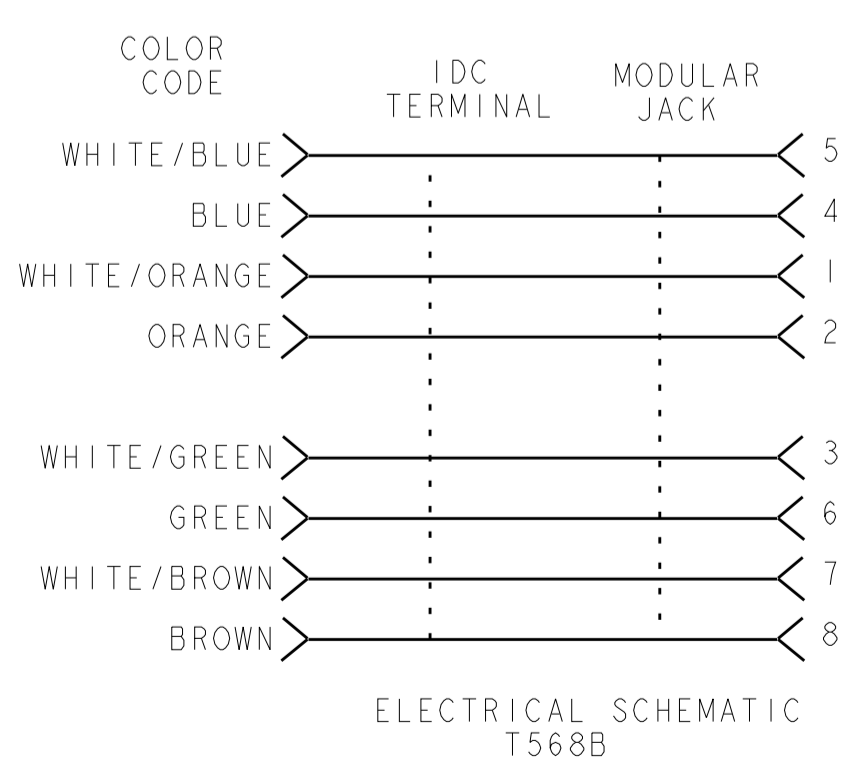
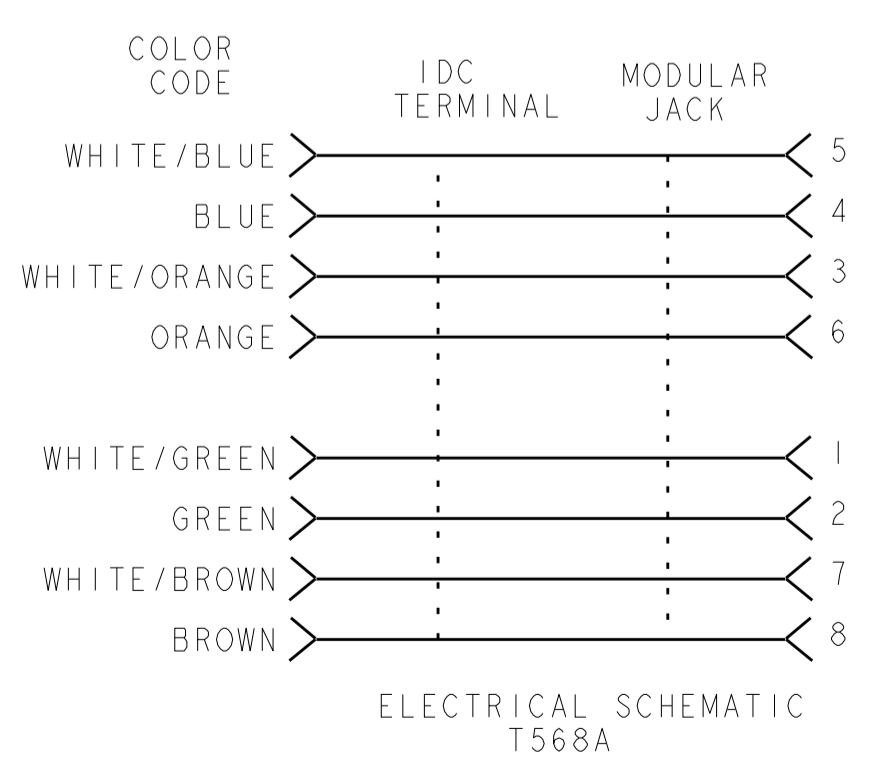
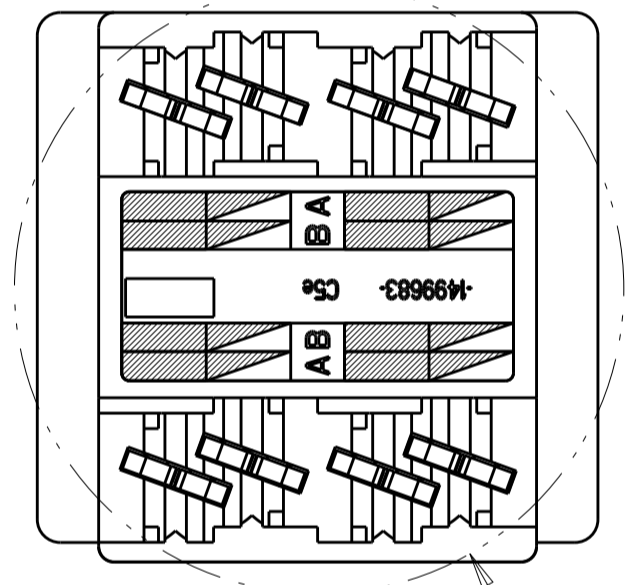
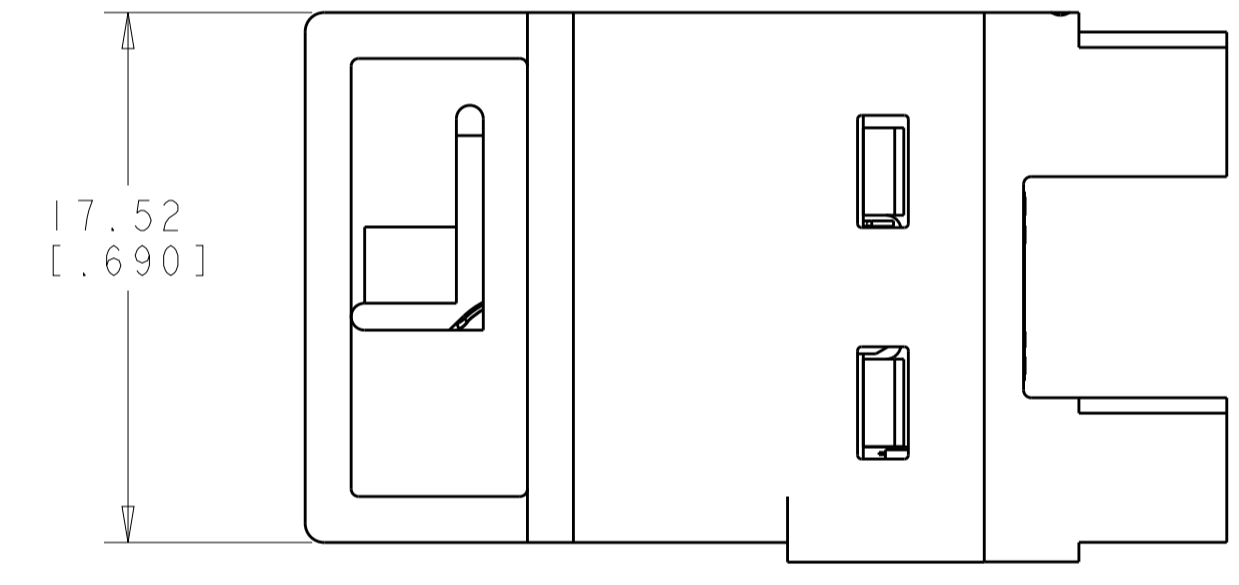
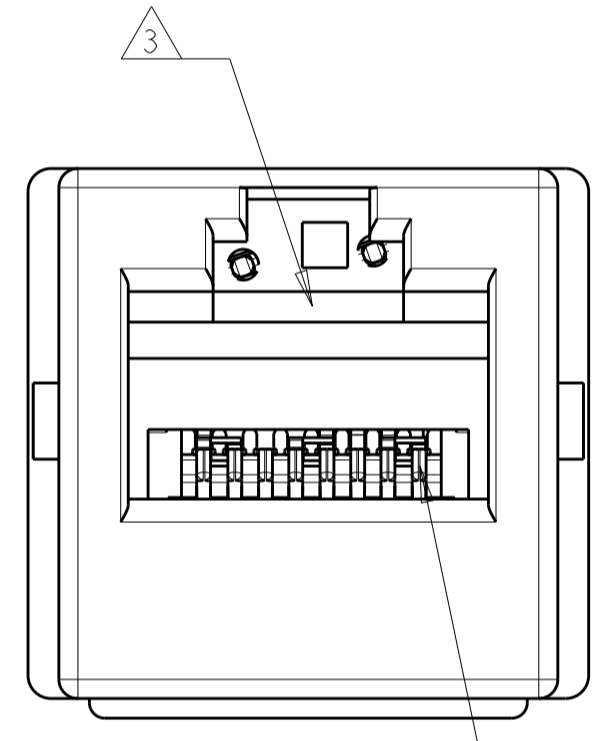

PACKAGE	HOUSING COLOR	PART NUMBER
▲	ELECTRIC IVORY	1-1499683-1
	GREEN	1499683-9
	YELLOW	1499683-8
	BLUE	1499683-6
	WHITE	1499683-3
	BLACK	1499683-2
	LIGHT ALMOND	1499683-1

THIS DRAWING IS A CONTROLLED DOCUMENT.

OWN: J. MCNEAL 26FEB2006
CHK: P. PEPE 26FEB2006
APVD: P. PEPE 26FEB2006

TE Connectivity

ASSEMBLY, CAT5e, UTP, KLS SERIES

SIZE: A100779 C=1499683

SCALE: 4:1 SHEET: 1 OF 1 REV: E