

PART NUMBER	REV	FIRST USED
567902-1	C	854040-4

TERMINAL NAME:		VISIBLE PAD LTR		CRIMPING DATA	
PIN	SOCKET	CRIMP HEIGHT	WIRE SIZE		
171636	171637	.051 ±.002	(1)16 OR (2)20		
		.048 ±.002	18		
		NOT	USED		
		.042 ±.002	20		
CRIMP	SIZE	TYPE	RANGE		
WIRE	.070	F	20-16		
INSUL	.140	F	.079-.126 OR (2) .094		
FEED	APPL INST	SET UP GAGE	LAYOUT		
.472	AI SEE CUSTOMER MANUAL	NONE	L1284		
TERM APPL SPEC	114-5050	WIRE STRIP LENGTH	-		

SIM TO HDM 567251

QTY	REV	REF	DESCRIPTION	ITEM NO
				70
				69
				68
				67
				66
				65
				64
				63
				62
				61
				60
				59
				58
				57
				56
				55
				54
				53
				52
				51
				50
				49
				48
				47
				46
				45
				44
				43
				42
				41
				40
				39
				38
				37
				36
				35
				34
				33
				32
				31
				30
				29
				28
				27
				26
				25
				24
				23
				22
				21
				20
				19
				18
				17
				16
				15
				14
				13
				12
				11
				10
				9
				8
				7
				6
				5
				4
				3
				2
				1

THIS DRAWING IS A CONTROLLED DOCUMENT.

THIS DRAWING IS UNRELEASED. RELEASE FOR PUBLICATION BY AMP INCORPORATED. ALL RIGHTS RESERVED. © COPYRIGHT 19

LOC A
DIST 66

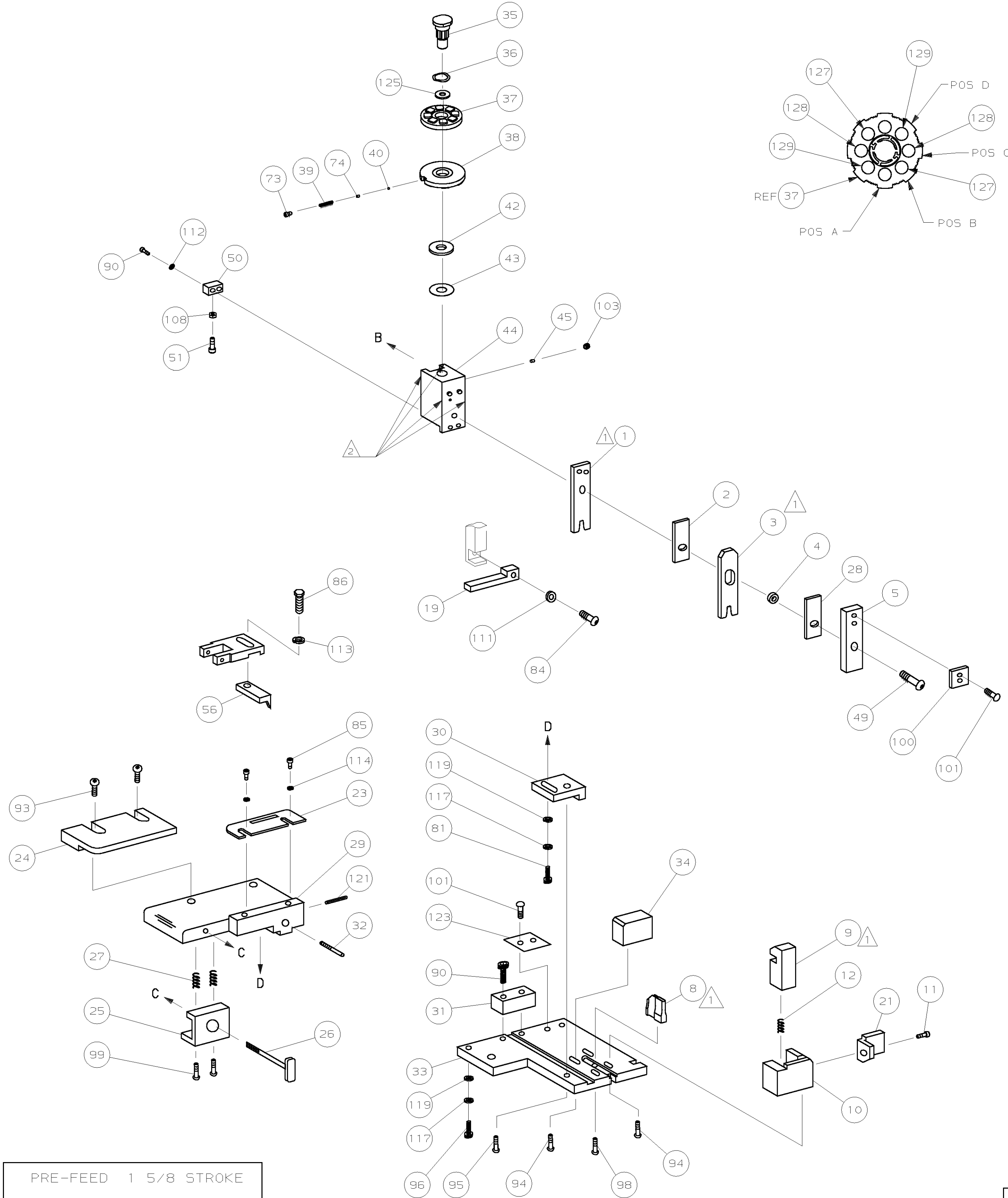

- 1 RECOMMENDED SPARE PARTS.
- 2 GREASE LIGHTLY.
- 3 ITEM NOT SHOWN

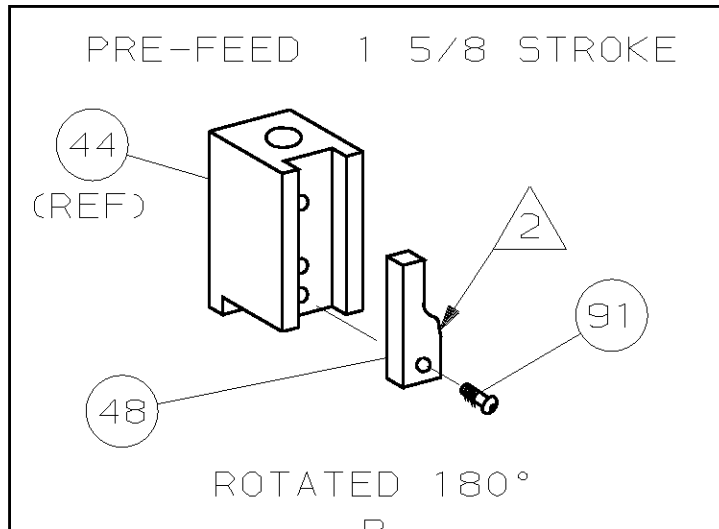

QTY	REV	REF	PART NO	DESCRIPTION	ITEM NO
2	-	C	2-354779-6	PIN, WIRE DISC (.3120)D	129
2	-	C	2-354779-0	PIN, WIRE DISC (.3090)C	128
2	-	C	3-354779-8	PIN, WIRE DISC (.3180)B	127
					126
1	-	A	986950-1	WASHER, FLAT PRECISION	125
					124
1	-	B	690701-2	PLATE, SERIAL NO.	123
					122
1	-	A	4-21028-0	PIN, SLT SPR(φ.093x.75)ST GDE PL	121
					120
2	-	A	21899-2	WASHER, FLAT (#10)S G ADJ BLK	119
					118
2	-	A	21024-5	WASHER, LOCK (#10)ADJ BLOCK	117
					116
					115
2	-	A	21024-2	WASHER, LOCK (#4)FRONT STP GUIDE	114
REF	-	A	21024-4	WASHER, LOCK (#8)FEED FINGER	113
2	-	A	21024-4	WASHER, LOCK (#8)DEP-HOLD	112
REF	-	A	21024-4	WASHER, LOCK (#8)STRIPPER	111
					110
					109
1	-	A	21018-5	NUT, HEX (#6)HOLD DOWN	108
					107
					106
					105
1	-	A	21009-2	SCR, SKT 5ET (1/4-20x.25 LW)RAM	104
					103
					102
4	-	A	21017-2	SCR, DRIVE (#2x.19)ID PLATE	101
1	-	B	819347-1	PLATE, IDENTIFICATION	100
2	-	A	3-21002-0	SCR, BHC (10-32x.88)DRAG	99
1	-	A	22733-8	SCR, BHC (8-32x.38 LW)ANVIL	98
					97
1	-	A	3-21000-8	SCR, SHC (10-32x.88)MOUNTING	96
1	-	A	2-21002-7	SCR, BHC (10-32x.50)S6 ADJ BLK	95
4	-	A	2-21002-2	SCR, BHC (8-32x.50)SHEAR-TERM SUP	94
2	-	A	2-21002-2	SCR, BHC (8-32x.50)R STP GDE	93
					92
1	-	A	1-21002-7	SCR, SHC (6-32x.50)CAM	91
4	-	A	2-21000-7	SCR, SHC (8-32x.50)SCR BLK	90
					89
					88
					87
REF	-	A	2-22603-0	SCR, HEX HD (8-32x.31)FEED FINGER	86
2	-	A	1-21000-3	SCR, SHC (4-40x.25)F ST GUIDE	85
REF	-	A	22733-9	SCR, BHC (8-32x.50 SL)STRIPPER	84
					83
					82
1	-	A	3-22603-1	SCR, HEX (10-32x.38)50 ADJ BL	81
					80
					79
					78
2	-	B	463310-4	BLADE, STRIPPING (#18)	77
					76
					75
1	-	A	690603-1	SPRING, ASSIST	74
1	-	A	23030-1	SCR, SKT CAP (6-32x.25)CP DSC	73
					72
					71

QTY	REV	REF	PART NO	DESCRIPTION	ITEM NO
-1	U/M				
REVISION OF EACH ASSY NO (WHEN BLANK, USE DWG REVISION)					
QTY	REV	REF	PART NO	DESCRIPTION	ITEM NO
-1	U/M				
REVISION OF EACH ASSY NO (WHEN BLANK, USE DWG REVISION)					

DIMENSIONS IN INCHES. DO NOT SCALE PRINT. TOLERANCES UNLESS OTHERWISE SPECIFIED:

2 PLC DEC ±
3 PLC DEC ±
4 PLC DEC ±

ANGLES ±
SURF TEXTURE: ✓
REMOVE BURRS, BREAK SHARP EDGES R.015 MAX

MATL - HT TR - FIN -

DR 11/3/93 APP 11-9-93
M. O'BRINE B. WOLFE
CHK 11-9-93 REL 11/18/93
C. ERISMAN G. OCHENIS

AMP AMP Incorporated
Harrisburg, PA 17105-3608

NAME: STRIPPER CRIMPER APPLICATOR MACHINE REF: STRIPPER CRIMPER

SCALE: - DWG NO: 567902 SHEET: 1 OF 1 REV: C

CASE CODE: 00779 CUSTOMER AND ASSEMBLY DRAWING RESTRICTED TO

567902