

THIS DRAWING IS UNPUBLISHED. RELEASED FOR PUBLICATION , 19

© COPYRIGHT 19 BY AMP INCORPORATED. ALL INTERNATIONAL RIGHTS RESERVED.

PROJ LGC DIST
5049 DF A0

		REVISIONS			
ZONE	LTR	DESCRIPTION	DATE	APPD	
	0	RLSE/NPR 89-015 CCT	2-89	EH	
	A	REV PER ECN DF-1837 TW	5-89	EH	
✓	B	REV PER DF-3934 CT	6-89	12-70	

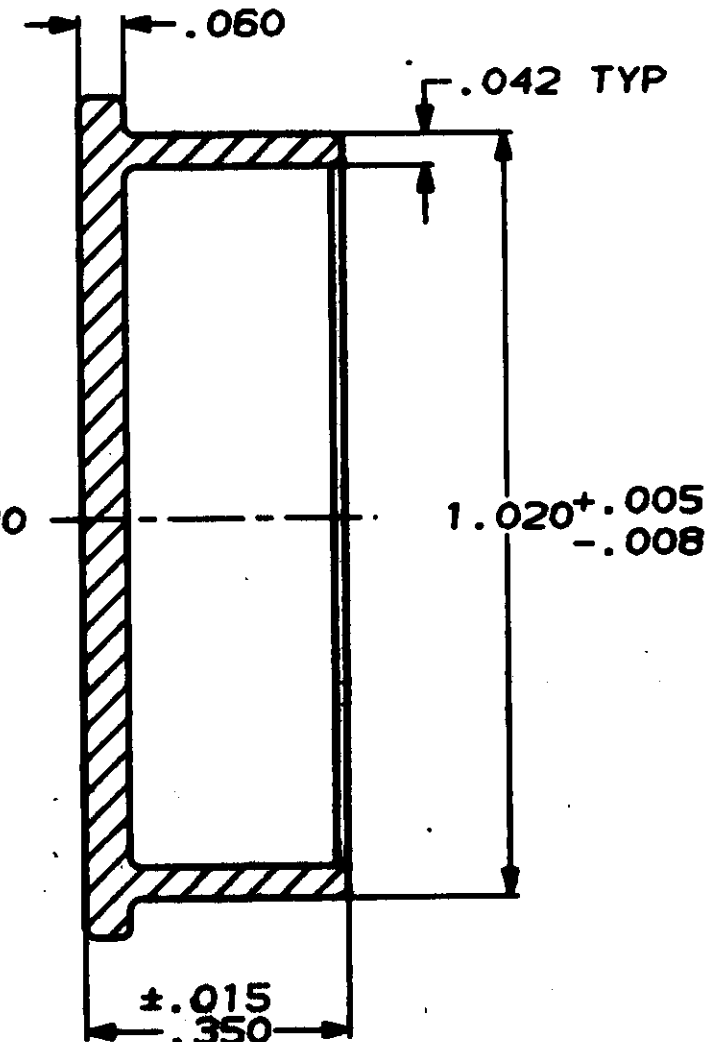
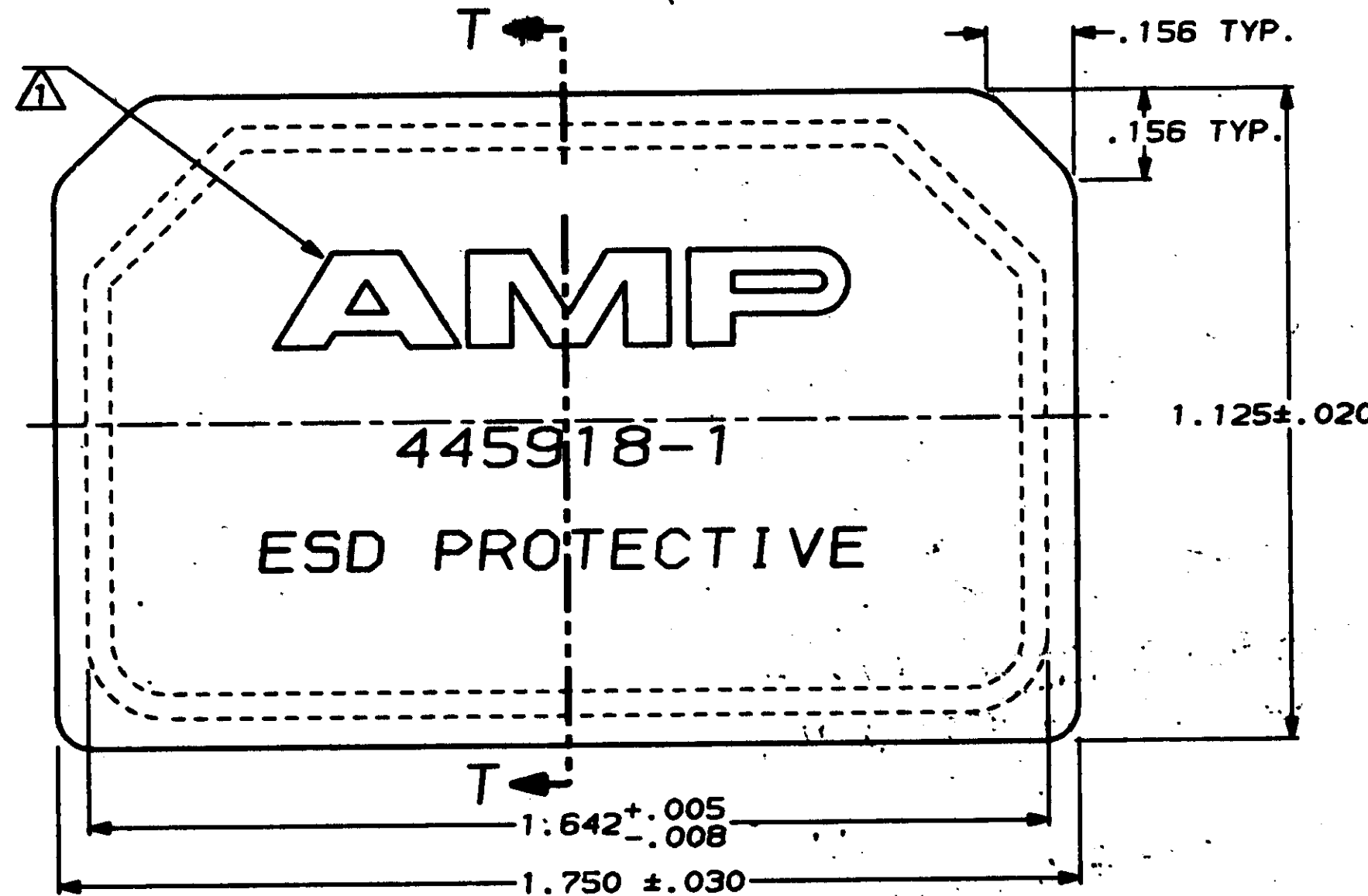

SECTION T-T

⚠ MARKING IS MOLDED IN AND RAISED .005-.012 ABOVE SURFACE APPROX: AS SHOWN.

DO NOT SCALE PRINT. UNLESS SPECIFIED DIMENSIONS IN INCHES TOLERANCES ON: Ø PLC DEC ± .005 Ø PLC DEC ± .008 ANGLES ± .5	ON 2-15-89 C.E. THOMPSON CHK 3-1-89 E. HENNING APPD 3-1-89 E. HENNING APPD 3-1-89 E. HENNING
MATERIAL CONDUCTIVE THERMOPLASTIC	PRODUCT SPEC -
FINISH BLACK	APPLICATION SPEC -
	RETRY -

SIZE B	PCN NO 00779	DRAWING NO 445918
SCALE 4:1	SHEET 1 OF 1	

445918-1	
PART NO	
AMP AMP INCORPORATED Harrisburg, Pa. 17106	
DUST COVER, ARINC 404 DUAL RECEPTACLE	

CUSTOMER DRAWING