

10 9 8 7 6 5 4 3 2 1

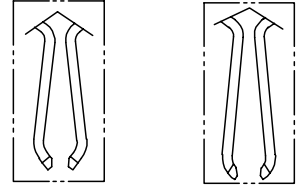

SHORT BLADE OPTION LONG BLADE OPTION
DETAIL R
 (SEE TABLE FOR BLADE OPTION)

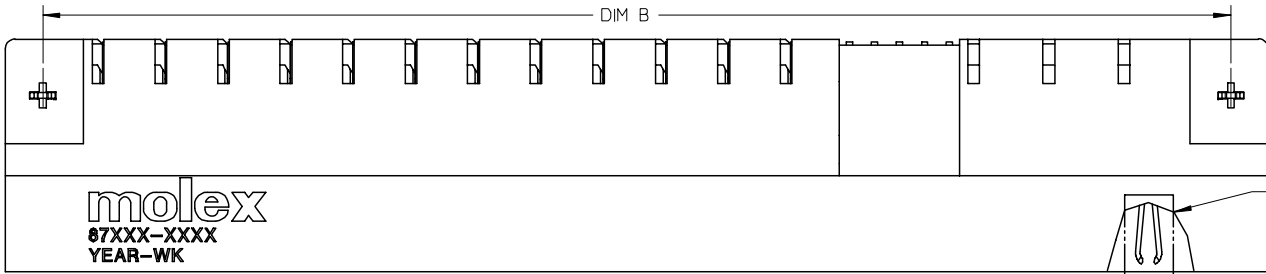
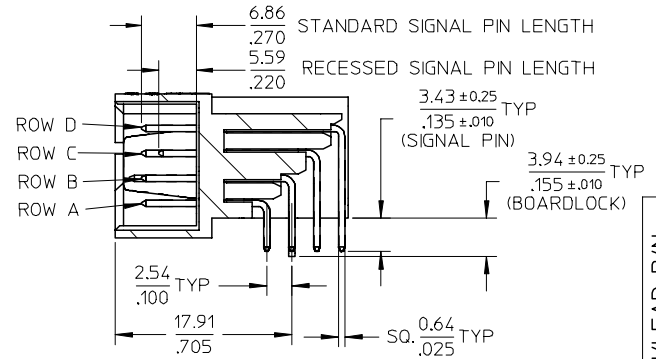
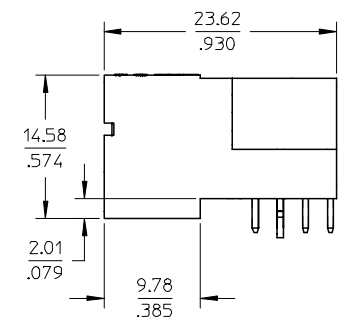
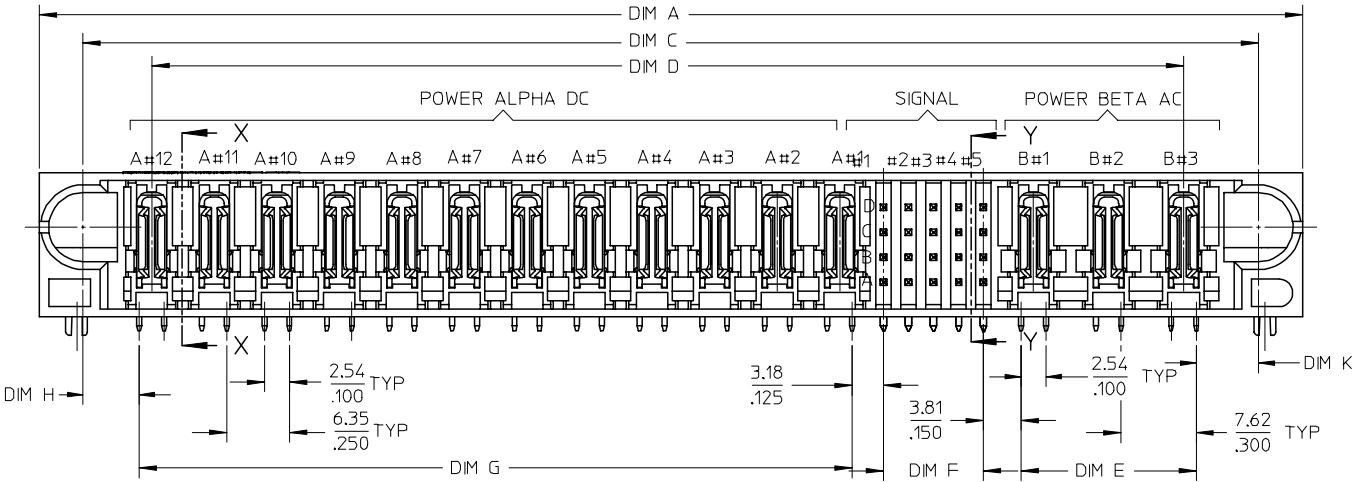

SECTION Y-Y
 (TERMINAL LOCKING DETAIL NOT SHOWN)

OBS TIN/LEAD P/N	EC NO: S2006-0767	2006/04/03
	DRWN:MLONG	2006/04/03
	CHKD:NAGESHKN	2006/04/03
	APPR:PTLIM	2006/04/06
REV	DESCRIPTION	
D		

QUALITY SYMBOLS	▽=0
	▽=0

GENERAL TOLERANCES (UNLESS SPECIFIED)	mm	INCH
	4 PLACES ± ---	± ---
	3 PLACES ± ---	± .010
	2 PLACES ± 0.25	± ---
	1 PLACE ± ---	± ---
	ANGULAR ± 3 °	
DRAFT WHERE APPLICABLE MUST REMAIN WITHIN DIMENSIONS		

DIMENSION STYLE		MM/IN
DRAWN BY	DATE	TITLE
BHLOW	2003/10/02	DC/AC POWER CONN. HEADER P(DC)-S-P(AC) CONFIG. R/A, T/H, BOARD-LOCK
CHECKED BY	DATE	
PTLIM	2003/10/21	MOLEX INCORPORATED
APPROVED BY	DATE	
SKTOH	2003/10/21	
MATERIAL NO.	DOCUMENT NO.	SHEET NO.
SEE TABLE	SD-87663-020	1 OF 3

SCALE	DESIGN UNITS	THIRD ANGLE PROJECTION
NTS	METRIC	

THIS DRAWING CONTAINS INFORMATION THAT IS PROPRIETARY TO MOLEX INCORPORATED AND SHOULD NOT BE USED WITHOUT WRITTEN PERMISSION

9 8 7 6 5 4 3 2 1

10 9 8 7 6 5 4 3 2 1

F
E
D
C
B
A

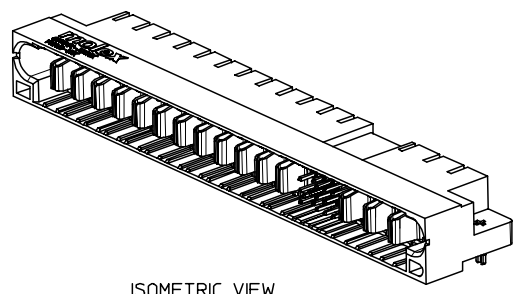

ISOMETRIC VIEW
3P(AC)-24S-12P(DC) FOR ILLUSTRATION

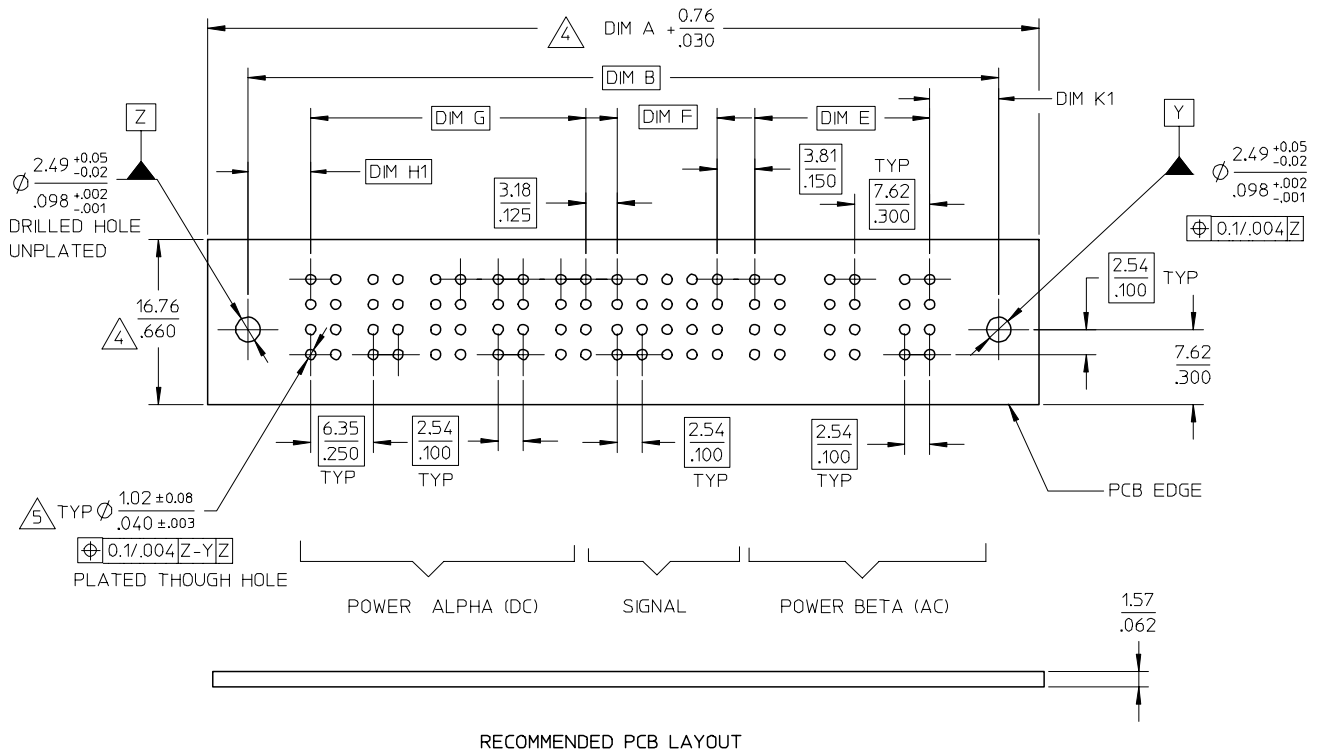

NOTES:

1. MATERIALS:-
HOUSING - LCP, GLASS FILLED, UL94V-0. COLOUR: BLACK
SIGNAL TERMINAL - COPPER ALLOY
POWER TERMINAL - COPPER ALLOY
2. FINISH :-
SIGNAL & POWER CONTACTS
0.76 MICROMETER MINIMUM GOLD (Au) AT CONTACT AREA AND
2.54 MICROMETER MINIMUM TIN AT SOLDERTAIL AREA
OVER 1.27 MICROMETER MINIMUM NICKEL (Ni) UNDERPLATE.
3. PRODUCT SPECIFICATION : PS-87663-006.
4. COMPONENT STAY AWAY FROM CONNECTOR.
5. PCB NOTE FOR DIAMETER 1.02/.040 PLATED HOLE.
- DRILLED HOLE SIZE IS 1.15/ .0453.
- PLATE WITH 0.007 / .0003 MINIMUM TIN OVER 0.03/.001
TO 0.08/.003 COPPER PLATING TO ACHIEVE 1.02±0.08/.040±.003 HOLE.
6. MANUFACTURER LOGO, PART NUMBER AND YEAR-WEEK CODE.
7. LONG AND SHORT CONTACT POWER BLADE OPTIONS ARE AVAILABLE
FOR DIFFERENT CUSTOMERS REQUIREMENT.

OBS TIN/LEAD P/N EC NO: S2006-0767 DRWN:MLONG CHKD:AGESHKN APPR:PTLIM	REV D	DESCRIPTION 2006/04/03 2006/04/03 2006/04/06	QUALITY SYMBOLS ▽=0 ∇=0	GENERAL TOLERANCES (UNLESS SPECIFIED)	DIMENSION STYLE MM/IN	SCALE NTS	DESIGN UNITS METRIC	THIRD ANGLE PROJECTION
				4 PLACES ± --- ± --- 3 PLACES ± --- ± .010 2 PLACES ± 0.25 ± --- 1 PLACE ± --- ± ---	DRAWN BY BHLOW CHECKED BY PTL IM APPROVED BY SKTOH	DATE 2003/10/02 2003/10/21 2003/10/21	TITLE DC/AC POWER CONN. HEADER P(DC)-S-P(AC) CONFIG. R/A, T/H, BOARD-LOCK	
				ANGULAR ± 3 °	MATERIAL NO. SEE TABLE	DATE 2003/10/21	MOLEX INCORPORATED	
			DRAFT WHERE APPLICABLE MUST REMAIN WITHIN DIMENSIONS	SIZE A3	DOCUMENT NO. SD-87663-020	SHEET NO. 2 OF 3		

9 8 7 6 5 4 3 2 1

PART NUMBER	P-S-P CONFIGURATION			DIM A	DIM B	DIM C	DIM D	DIM E	DIM F	DIM G	DIM H	DIM H1	DIM K	DIM K1	POWER BLADE OPTIONS		RECESSED SIGNAL PIN		VOID PIN LOCATION
	POWER ALPHA	DC SIGNAL	POWER BETA AC												DIM Z ±0.13/.005	LOCATION	LENGTH	LOCATION	
87663-2000	12	20	3	128.27 5.050	120.65 4.750	119.38 4.700	104.78 4.125	17.78 .700	10.16 .400	72.39 2.850	5.72 .225	6.35 .250	6.35 .250	6.99 .275	14.12 / .556	ALL	5.59/.220	A1,A3,C3 .D1,D2	NIL
87663-2001	8	12	3	97.79 3.850	90.17 3.550	88.90 3.500	74.30 2.925	17.78 .700	5.08 .200	46.99 1.850	5.72 .225	6.35 .250	6.35 .250	6.99 .275	14.12 / .556	ALL	NIL	NIL	NIL
87663-2002	1	32	3	64.14 2.525	56.52 2.225	55.25 2.175	42.55 1.675	17.78 .700	17.78 .700	2.54 .100	5.08 .200	5.72 .225	5.08 .200	5.72 .225	14.12 / .556	ALL	NIL	NIL	A5,B5,C5,D5 A6,B6,C6,D6 B7,C7 A8,B8,C8,D8

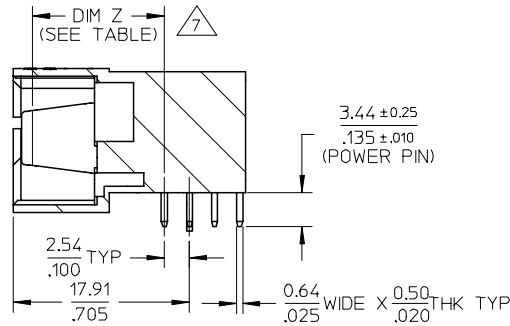

(TERMINAL LOCKING DETAIL NOT SHOWN)

SECTION X-X

OBS TIN/LEAD P/N EC NO: S2006-0767 DRWN:MLONG CHKD:WAGESHKN APPR:PTLIM	REV D	DESCRIPTION	QUALITY SYMBOLS	GENERAL TOLERANCES (UNLESS SPECIFIED)	DIMENSION STYLE		SCALE	DESIGN UNITS	THIRD ANGLE PROJECTION
			▽=0		mm	INCH			
			∇=0		MM/IN				
					DRAWN BY DATE				
				4 PLACES ± --- ± ---	BHLOW	2003/10/02	TITLE DC/AC POWER CONN. HEADER P(DC)-S-P(AC) CONFIG. R/A, T/H, BOARD-LOCK		
			3 PLACES ± --- ± .010	CHECKED BY	DATE				
			2 PLACES ± 0.25 ± ---	PTLIM	2003/10/21				
			1 PLACE ± --- ± ---	APPROVED BY	DATE				
				ANGULAR ± 3 °	SKTOH	2003/10/21	MOLEX INCORPORATED		
				DRAFT WHERE APPLICABLE MUST REMAIN WITHIN DIMENSIONS	MATERIAL NO.	DOCUMENT NO.			
					SIZE	SEE TABLE	SD-87663-020	SHEET NO.	
					A3	THIS DRAWING CONTAINS INFORMATION THAT IS PROPRIETARY TO MOLEX INCORPORATED AND SHOULD NOT BE USED WITHOUT WRITTEN PERMISSION		3 OF 3	