

REV.	DATE	DESCRIPTION
NC	10/01/97	INITIAL RELEASE
NC	04/19/07	REVISE PLATING TO NEXCOTE / UPDATE DRAWING FORMAT

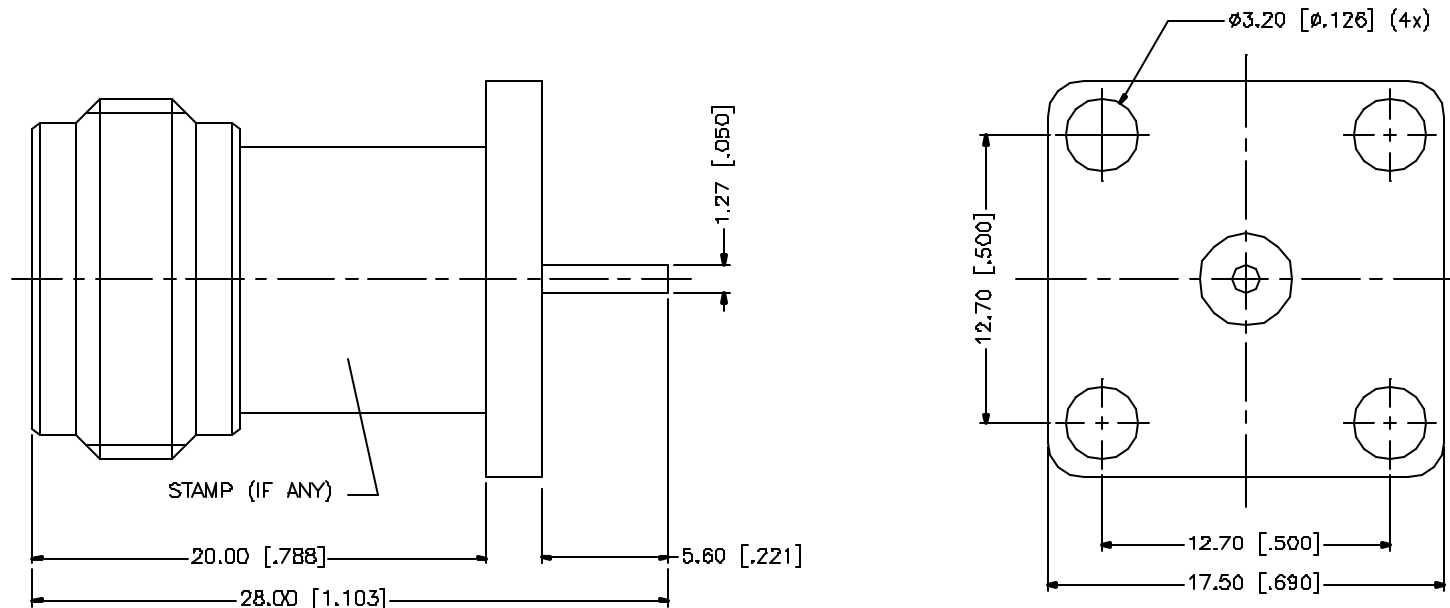

				UNLESS OTHERWISE SPECIFIED DIMENSIONS ARE IN MILLIMETERS. DIMENSIONS IN [ ] ARE IN INCHES AND FOR CUSTOMER REFERENCE ONLY.	APPROVALS	DATE	<b>Amphenol Connex</b>			
8				UNLESS OTHERWISE SPECIFIED TOLERANCES FOR MILLIMETERS ARE: 0.5 - 8mm ± 0.20mm 8 - 30mm ± 0.40mm 30 - 120mm ± 0.50mm  UNLESS OTHERWISE SPECIFIED TOLERANCES FOR INCHES ARE: .020 - .315 = ± 0.007" .315 - 1.180 = ± 0.015" 1.180 - 4.724 = ± 0.020"  DO NOT SCALE DRAWING	DRAWN	G.R.S.				04/19/07
7					CHECKED			PART NO. <b>172190</b>		
6					ISSUED					
5					SHEET	1 OF 1		REV. A	SIZE A	SCALE NA
4										
3	CONTACT PIN	PHOS. BRONZE	GOLD		1					
2	INSULATOR	TEFLON	NATURAL		1					
1	BODY	BRASS	NEXCOTE		1					
	DESCRIPTION	MATERIAL	FINISH	QTY						
					CAD FILE	C:/172/172190.DWG				