

# P36 series

Low profile rotary code switches

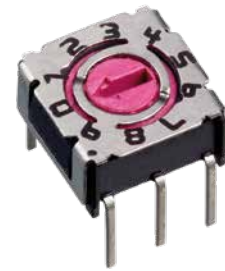

## DISTINCTIVE FEATURES

- 3 actuator types
- Sub-miniature size
- Solder and flux sealed, washable



## ENVIRONMENTAL SPECIFICATIONS

- Operating temperature: -50 °C to +125 °C (-58 °F to +257 °F)



## ELECTRICAL SPECIFICATIONS

- Operating voltage :  $\leq 42$  V
- Contact load, static :  $\leq 0.4$  A
- Contact load, dynamic :  $\leq 0.1$  A
- Initial contact resistance : 80 m $\Omega$  max.
- Insulation resistance : 100 M $\Omega$  min.



## MATERIALS

- Base : UL94-V0, high temperature thermoplastic
- Cover : stainless steel
- Actuator : PA 4.6 nylon
- Contacts : gold over nickel plated phosphor bronze
- Terminals : tin plated



## PCB MOUNTING

SURFACE MOUNT

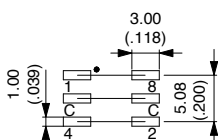

THROUGH-HOLE

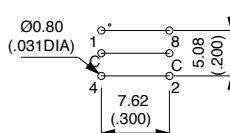

The company reserves the right to change specifications without notice.

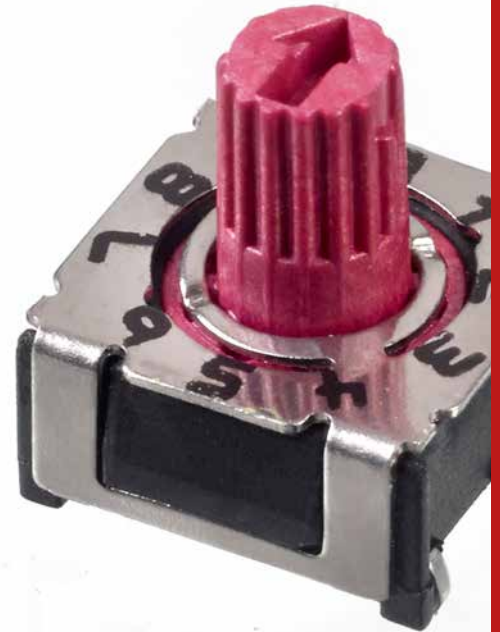

# P36 series

Low profile rotary code switches



## SOLDERING

- DIN CEI 68-2-20
- Manual soldering : 340 °C (644 °F) max. for 2 seconds max.
- Wave soldering : 280 °C (536 °F) max. for 5 seconds max.
- Reflow soldering : 260 °C (500 °F) max. for 10 seconds max.



## PACKAGING

P36S1..

1,300 pieces per reel

dim.A = 22.4 mm

dim B = 16.4 mm

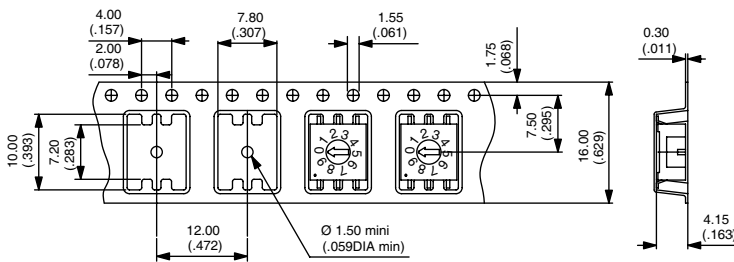

P36S3..

P36S8..

600 pieces per reel

dim.A = 30.4 mm

dim B = 24.4 mm

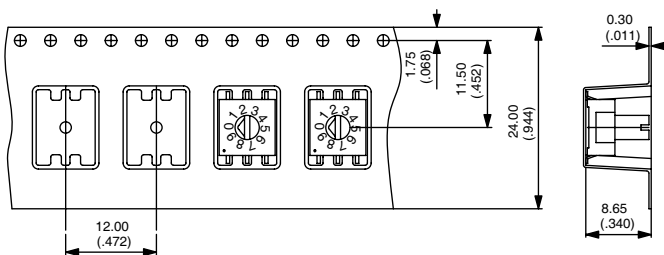

Reels : To order a SMT product with tape & reel packaging, add "TR" at the end of its part number.

Tubes : 50 pieces (through-hole or SMT) per tube.

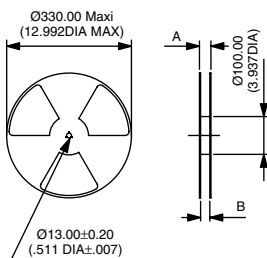

# P36 series

Low profile rotary code switches

## BUILD YOUR PART NUMBER

P36

SERIES

MOUNTING

ACTUATORS

CODES

TERMINALS

|        |               |
|--------|---------------|
| (none) | Through-hole  |
| S      | Surface mount |

|   |                 |
|---|-----------------|
| 1 | Screwdriver     |
| 3 | Spindle         |
| 8 | Slotted spindle |

|    |                        |
|----|------------------------|
| 01 | BCD                    |
| 02 | BCD complement         |
| 03 | Hexadecimal            |
| 06 | Hexadecimal complement |

|        |                                  |
|--------|----------------------------------|
| (none) | Straight or SMT                  |
| V      | Crimped                          |
| L254   | Right angle, spacing 2.54 (.100) |

## ABOUT THIS SERIES

On the following pages, you will find successively basic part numbers of switches and options in the same order as in above chart.

### THROUGH-HOLE



P36

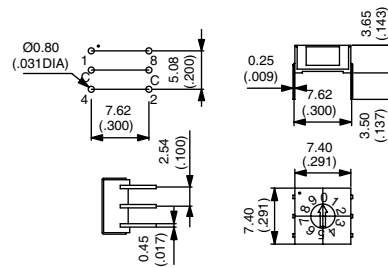

### SURFACE MOUNT



P36S

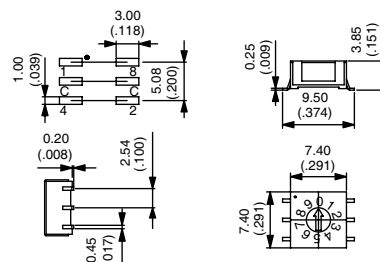

# P36 series

Low profile rotary code switches

## ACTUATORS

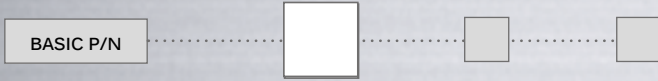

- 1 Screwdriver
- 3 Spindle
- 8 Slotted spindle

**Actuator colour**  
 depending on codes :  
 BCD : Red  
 BCD compl. : Orange  
 Hexadecimal : Grey  
 Hexadec. compl. : White

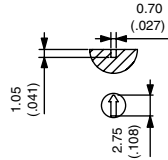

1

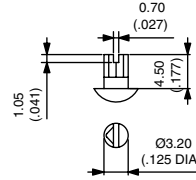

3

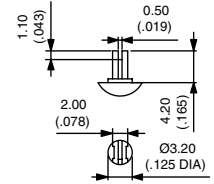

-8

## CODES

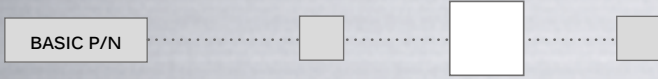

- 01 BCD
- 02 BCD complement
- 03 Hexadecimal
- 06 Hexadecimal complement

| POSITION | C | 1 | 2 | 4 | 8 | MARKING |
|----------|---|---|---|---|---|---------|
| 0        | ● |   |   |   |   | 0       |
| 1        | ● | ● |   |   |   | 1       |
| 2        | ● |   | ● |   |   | 2       |
| 3        | ● | ● | ● |   |   | 3       |
| 4        | ● |   |   | ● |   | 4       |
| 5        | ● | ● |   |   | ● | 5       |
| 6        | ● |   | ● | ● |   | 6       |
| 7        | ● | ● | ● | ● |   | 7       |
| 8        | ● |   |   |   | ● | 8       |
| 9        | ● | ● |   |   | ● | 9       |

01

| POSITION | C | 1 | 2 | 4 | 8 | MARKING |
|----------|---|---|---|---|---|---------|
| 0        | ● | ● | ● | ● | ● | 0       |
| 1        | ● |   | ● |   | ● | 1       |
| 2        | ● | ● |   | ● | ● | 2       |
| 3        | ● |   |   | ● | ● | 3       |
| 4        | ● | ● | ● |   | ● | 4       |
| 5        | ● |   | ● |   | ● | 5       |
| 6        | ● | ● |   |   | ● | 6       |
| 7        | ● |   |   |   | ● | 7       |
| 8        | ● | ● | ● | ● |   | 8       |
| 9        | ● |   | ● | ● |   | 9       |

02

| POSITION | C | 1 | 2 | 4 | 8 | MARKING |
|----------|---|---|---|---|---|---------|
| 0        | ● |   |   |   |   | 0       |
| 1        | ● | ● |   |   |   | 1       |
| 2        | ● |   | ● |   |   | 2       |
| 3        | ● | ● | ● |   |   | 3       |
| 4        | ● |   |   | ● |   | 4       |
| 5        | ● | ● |   |   | ● | 5       |
| 6        | ● |   | ● | ● |   | 6       |
| 7        | ● | ● | ● | ● |   | 7       |
| 8        | ● |   |   |   | ● | 8       |
| 9        | ● | ● |   |   | ● | 9       |
| 10       | ● |   | ● |   | ● | 10      |
| 11       | ● | ● | ● |   | ● | 11      |
| 12       | ● |   |   | ● | ● | 12      |
| 13       | ● | ● |   |   | ● | 13      |
| 14       | ● |   | ● | ● | ● | 14      |
| 15       | ● | ● | ● | ● | ● | 15      |

03

| POSITION | C | 1 | 2 | 4 | 8 | MARKING |
|----------|---|---|---|---|---|---------|
| 0        | ● |   |   |   |   | 0       |
| 1        | ● | ● |   |   |   | 1       |
| 2        | ● |   | ● |   |   | 2       |
| 3        | ● | ● |   | ● |   | 3       |
| 4        | ● |   |   |   | ● | 4       |
| 5        | ● | ● |   |   | ● | 5       |
| 6        | ● |   | ● |   | ● | 6       |
| 7        | ● | ● | ● |   | ● | 7       |
| 8        | ● | ● | ● | ● |   | 8       |
| 9        | ● |   | ● | ● |   | 9       |
| 10       | ● | ● |   |   | ● | 10      |
| 11       | ● |   |   | ● |   | 11      |
| 12       | ● | ● | ● |   |   | 12      |
| 13       | ● |   | ● |   |   | 13      |
| 14       | ● | ● |   |   |   | 14      |
| 15       | ● |   |   |   |   | 15      |

06

## TERMINALS

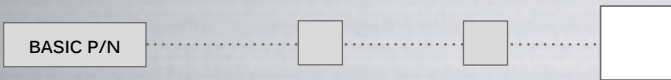

- (none) Straight or SMT
- V Crimped
- L254 Right angle, spacing 2,54 (.100)



(none)



V

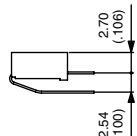
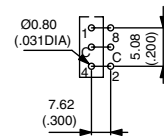
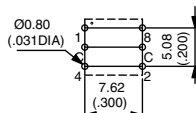

L254