

MATERIALS AND FINISHES

BODY BRASS
PLATED GOLD OVER NICKEL PHOSPHOR

CENTER CONTACT BERYLLIUM COPPER
PLATED GOLD OVER NICKEL

INSULATOR TEFLON

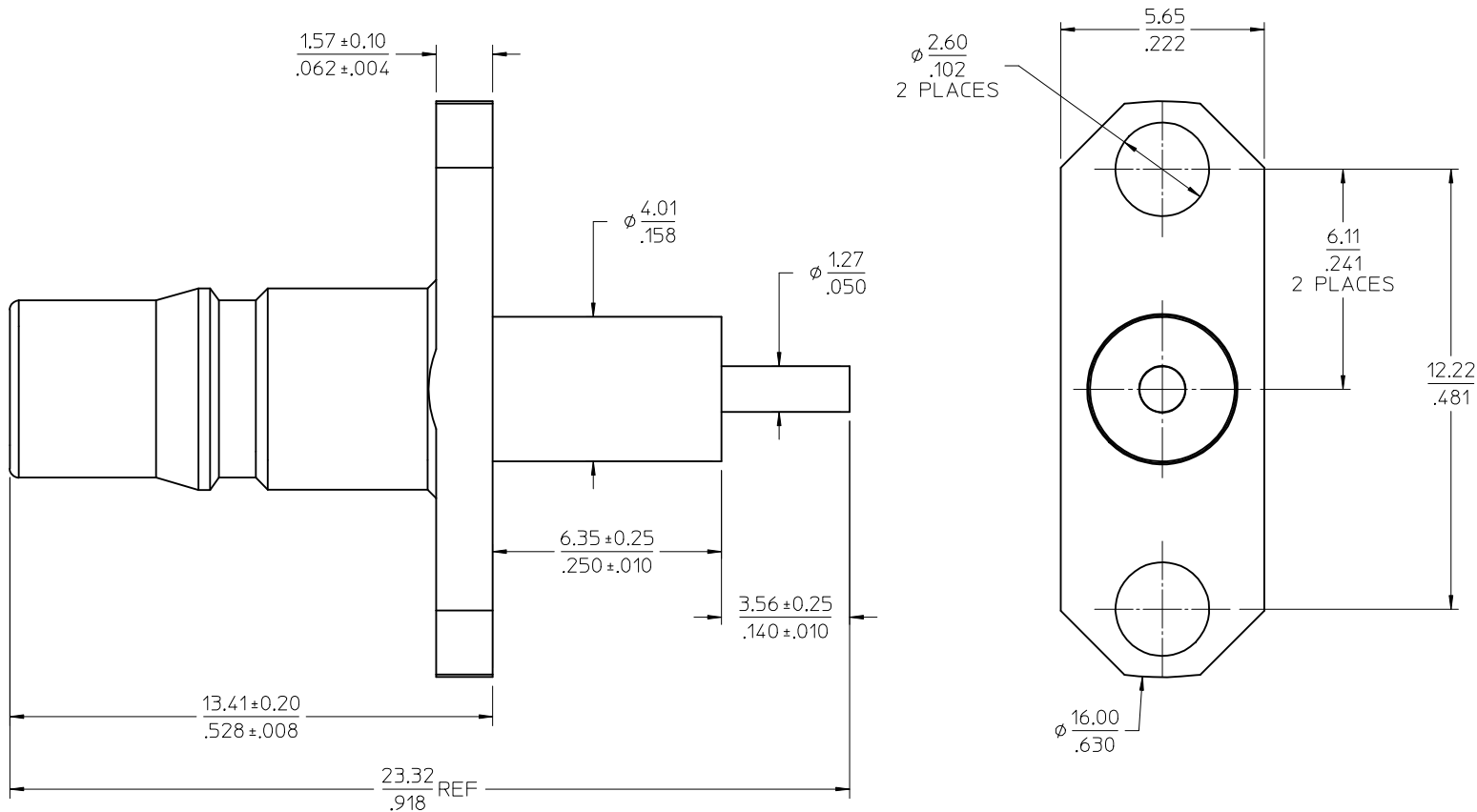
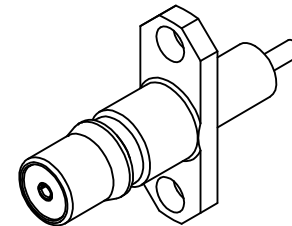

73254-0431	ONE PER BAG
73254-0430	TRAY
PART NO.	PACKAGING

PS-89675-1330	QMA
SPECIFICATION	DESCRIPTION

CHG: UPDATE PACKAGING FOR 73254-0430 PER RF15-E219	EC NO: URF2015-0667 2015/05/27	DRW: WRYEH	CHKD:	APPR: YCHENG	2015/05/29
DESCRIPTION	REV	A3			

QUALITY SYMBOLS	GENERAL TOLERANCES (UNLESS SPECIFIED)
▽=0	mm INCH
▽=0	4 PLACES ± --- ± ---
▽=0	3 PLACES ± --- ± ---
▽=0	2 PLACES ± --- ± ---
	1 PLACE ± --- ± ---
	0 PLACE ± --- ± ---
	ANGULAR ± 2 °
	DRAFT WHERE APPLICABLE MUST REMAIN WITHIN DIMENSIONS

DIMENSION STYLE	SCALE	DESIGN UNITS	THIRD ANGLE PROJECTION
MM/IN	10:1	METRIC	
DRAWN BY	DATE	TITLE	
JDW	2009/11/18	QMA JACK, STRAIGHT 2 HOLE FLANGE RECEPTACLE EWR-24255, QMA-JR	
CHECKED BY	DATE		
SSS	2009/11/18		
APPROVED BY	DATE		
JDW	2009/11/18		
MATERIAL NO.	DOCUMENT NO.		
SEE TABLE	SD-73254-043		
SIZE			
C			

SHEET NO.	1 OF 1
THIS DRAWING CONTAINS INFORMATION THAT IS PROPRIETARY TO MOLEX INCORPORATED AND SHOULD NOT BE USED WITHOUT WRITTEN PERMISSION	