

THIS DRAWING IS UNPUBLISHED.

RELEASED FOR PUBLICATION

20

© COPYRIGHT 20 BY -

ALL RIGHTS RESERVED.

LOC  
AL

DIST  
2

REVISIONS

P	LTR	DESCRIPTION	DATE	DWN	APVD
	E	CHANGED PCB LAYOUT	01SEP2008	J.S.	G.T.
	F	DELETED PART REVISION TABLE	18MAR2009	JS	PEG
	F1	REVISED PCB HOLES LAYOUT	04APR2011	AV	GT
	F2	REVISED PER ECR-13-009678	18SEP2013	RS	DD

### TYPICAL APPLICATION

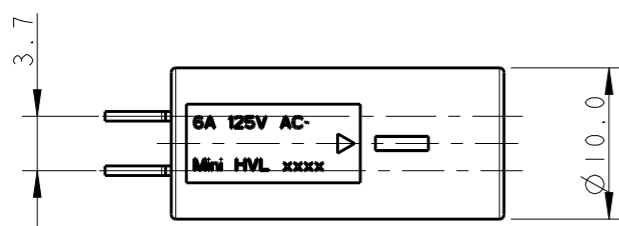
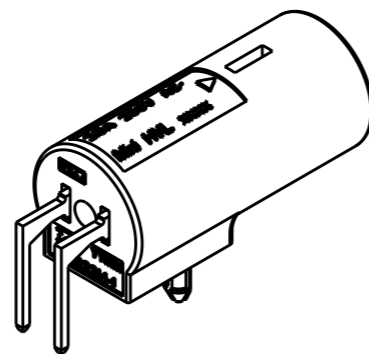
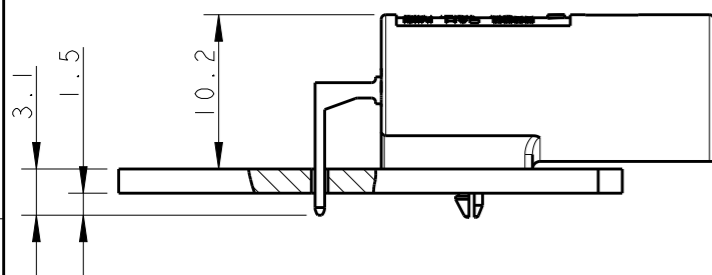

SECTION A - A  
SCALE 2:1

### PRINTED CIRCUIT BOARD LAYOUT FOR LOW VOLTAGE VERSION

TOLERANCES UNLESS OTHERWISE SPECIFIED ± 0.05  
PRINTED CIRCUIT BOARD THICKNESS: 1.6 mm NOMINAL

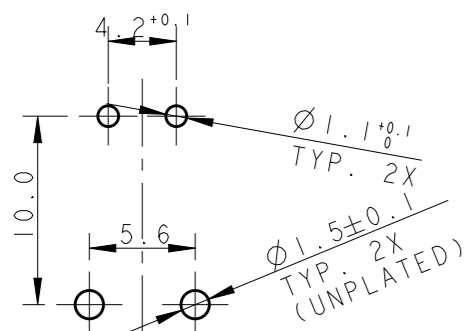

### HIGH VOLTAGE

P/N 293315-1;-2;-6;-7  
KEYING HV-1

P/N 293315-3  
KEYING HV-3

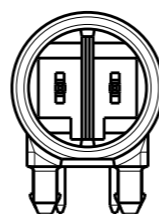
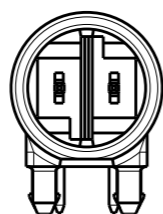

### LOW VOLTAGE

P/N 293315-4  
KEYING LV-1

P/N 293315-5  
KEYING LV-2

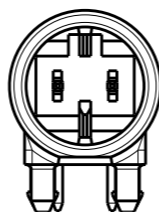
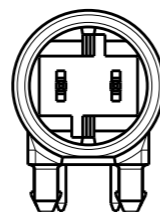

### PRINTED CIRCUIT BOARD LAYOUT FOR HIGH VOLTAGE VERSION

TOLERANCES UNLESS OTHERWISE SPECIFIED ± 0.05  
PRINTED CIRCUIT BOARD THICKNESS: 1.6 mm NOMINAL

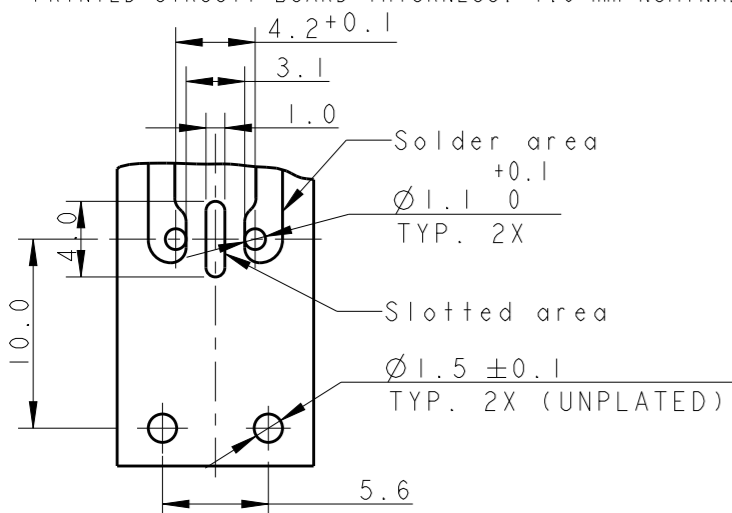

NOTE:

- 1 TIN PLATED CONTACTS
- 2 GOLD PLATED CONTACTS
- 3 MATERIAL HOUSING PA66 25%GFF UL94 V0

NOTE	KEYING	REMARKS	PART NUMBER	COLOR
2	HV-1	HIGH-VOLT 250 V AC	293315-7	BLACK
2	HV-1	HIGH-VOLT 250 V AC	293315-6	WHITE
1	LV-2	LOW-VOLT 42 V DC	293315-5	YELLOW
1	LV-1	LOW-VOLT 42 V AC	293315-4	LIGHT GREY
1	HV-3	HIGH-VOLT 125 V AC	293315-3	BLUE
1	HV-1	HIGH-VOLT 250 V AC	293315-2	BLACK
1	HV-1	HIGH-VOLT 250 V AC	293315-1	WHITE

THIS DRAWING IS A CONTROLLED DOCUMENT.

DWN 20JUN2007  
R. FRABONI

CHK J. SALO 11FEB2008

APVD L. BATTILO 11FEB2008

PRODUCT SPEC 108-94018

APPLICATION SPEC 114-32102

WEIGHT -

Customer Drawing

DIMENSIONS:	TOLERANCES UNLESS OTHERWISE SPECIFIED:
mm	
0 PLC	±-
1 PLC	±0.3
2 PLC	±0.1
3 PLC	±-
4 PLC	±-
ANGLES	±0.5°
MATERIAL	FINISH
-	-



NAME  
7.5 mm PCB CONNECTOR ASSEMBLY  
90 DEGREE MALE VERSION

SIZE CAGE CODE DRAWING NO RESTRICTED TO

A300779 C-293315

SCALE 2:1 SHEET 1 OF 1 REV F2