

THIS DRAWING IS UNPUBLISHED. RELEASED FOR PUBLICATION  
 © COPYRIGHT - By - ALL RIGHTS RESERVED.

LOC		DIST		REVISIONS			
P	LTR	DESCRIPTION		DATE	DWN	APVD	
	B3	REVISED PER ECR-13-015346		03OCT2013	KH	GJ	

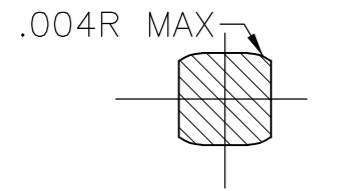

SECTION A-A  
20 X SCALE

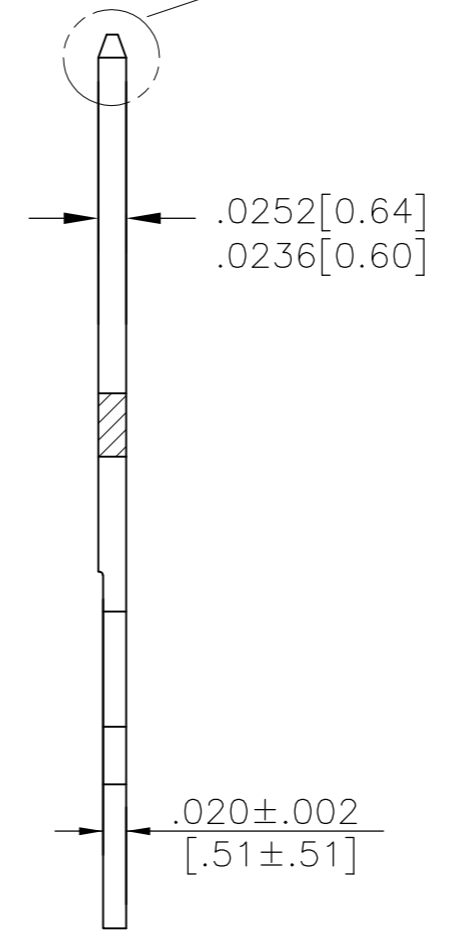
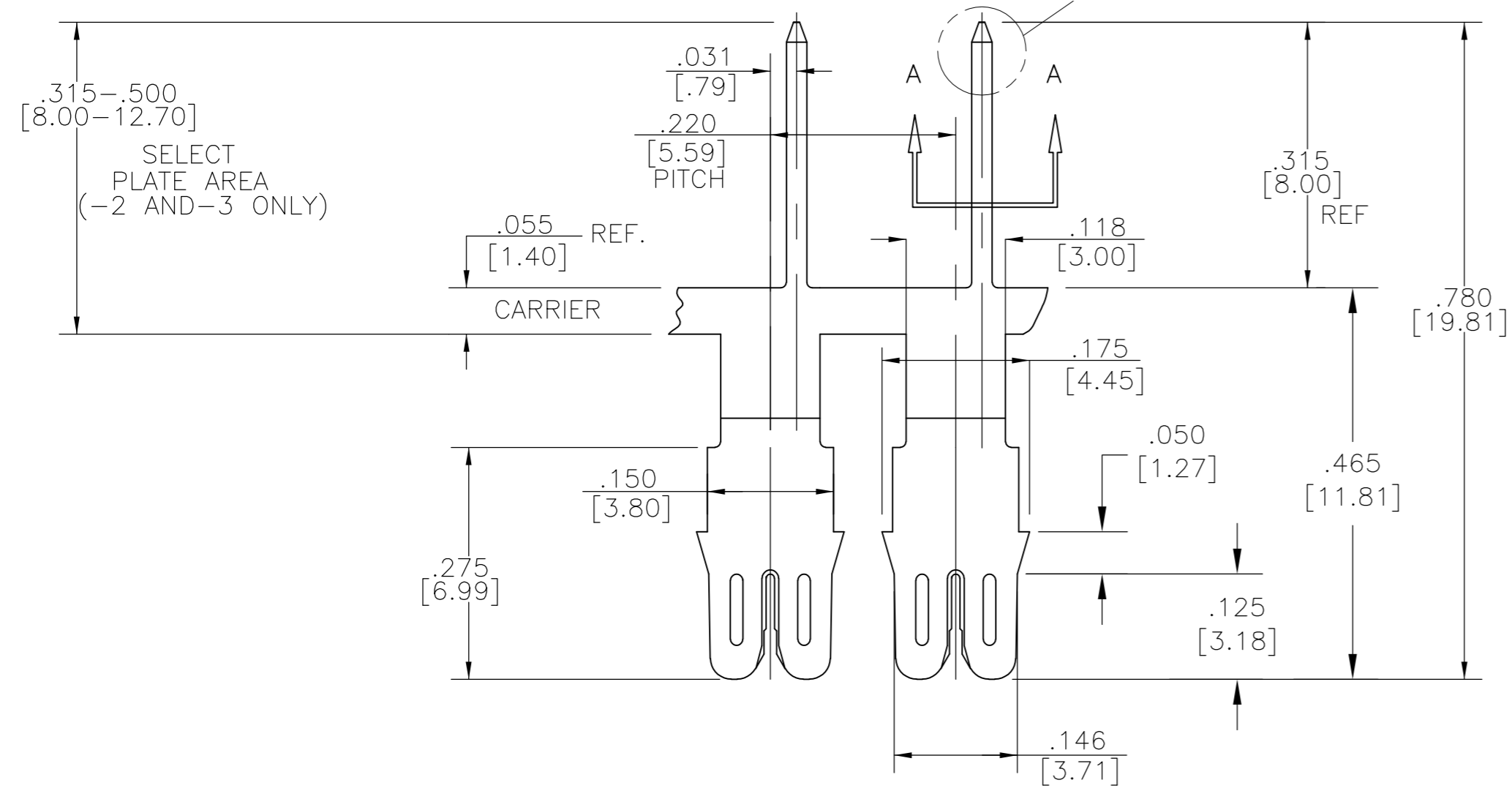
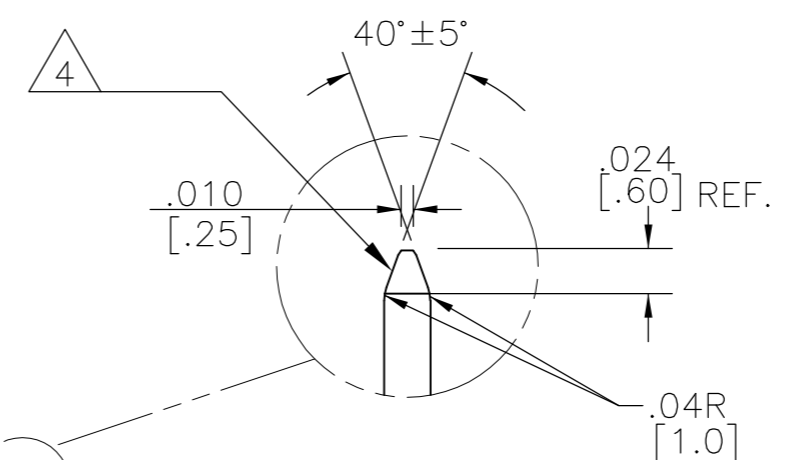
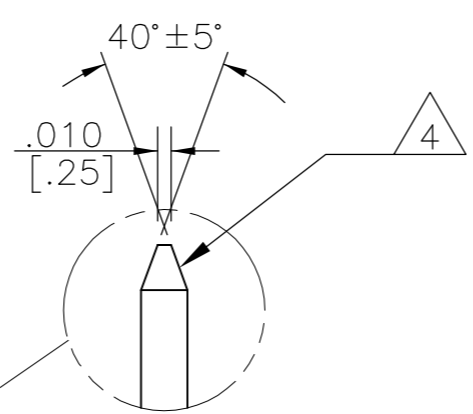

- SPECIFICATIONS:  
WIRE:(2) #20 AWG RESISTOR  
LEADS .031"  $\phi$ (0.812 mm)
- POCKET RECOMMENDATION:  
#1601424.
- TERMINAL APPLICATION TO COMPLY WITH  
TYCO ELECTRONICS SPECIFICATION 114-13166.  
CONSULT TYCO ELECTRONICS ENGINEERING  
FOR THE PROPER INSERTION DEPTH.
- TIP MAY BE RADIUSED WITHIN DIMENSIONS  
SHOWN AND HAVE CONVEX SIDES.
- TWO(2) TERMINALS SHOWN FOR ILLUSTRATION  
PURPOSES ONLY
- PRELIMINARY - NOT FOR PRODUCTION

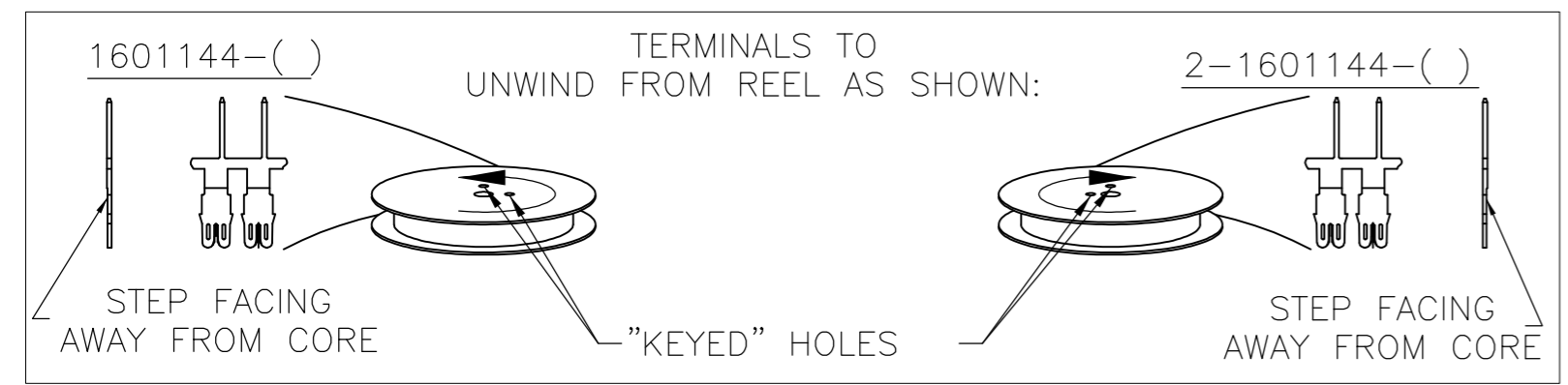
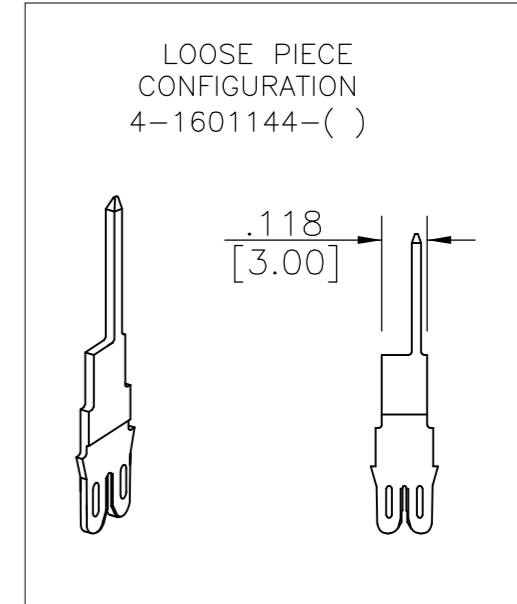

	-	-	-
	-	-	-
	PRE-TIN PLATE OVER NICKEL UNDERPLATE	-	$\triangle 6$ 1601144-4
	SELECTIVE POST TIN PLATE OVER NICKEL UNDERPLATE	159-003-120	1601144-3
OBSOLETE	POST TIN-LEAD PLATE OVER NICKEL UNDERPLATE	159-003-119	1601144-2
	UNPLATED	159-003-000	1601144-1
	FINISH	REFERENCE PART NUMBER	PART NUMBER
THIS DRAWING IS A CONTROLLED DOCUMENT.		DWN J.WELLER 11JAN2002	TE Connectivity NAME MULTIPLE WIRE I.D.C.TO OFFSET SQUARE PIN SIAMEZE TERMINAL
DIMENSIONS: INCHES		CHK M.FEHER 11JAN2002	
TOLERANCES UNLESS OTHERWISE SPECIFIED:		APVD K.RANDOLPH 11JAN2002	
0 PLC $\pm$ - 1 PLC $\pm$ - 2 PLC $\pm$ .01[0.13] 3 PLC $\pm$ .005[0.26] 4 PLC $\pm$ - ANGLES $\pm$ 2'		PRODUCT SPEC	
MATERIAL BRASS, 3/4 HARD	FINISH SEE TABLE	APPLICATION SPEC $\triangle 3$	RESTRICTED TO
CUSTOMER DRAWING		WEIGHT -	SIZE A2 CAGE CODE 00779 DRAWING NO. C=1601144
		SCALE 1:1	SHEET 1 of 1 REV B3