

THIS DRAWING IS UNPUBLISHED. RELEASED FOR PUBLICATION
 © COPYRIGHT - By - ALL RIGHTS RESERVED.

LOC HB DIST -

REVISIONS

P	LTR	DESCRIPTION	ECO	DATE	DWN	APVD
B3		ADD NEW PN	ECO-16-017849	12-DEC-16	XR,L	HL,C
B2		ADD A NEW PN	ECO-14-011106	18-JUL-14	XL,Y	B,F

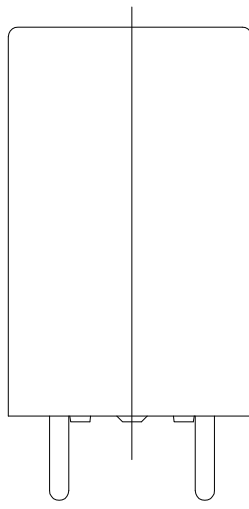
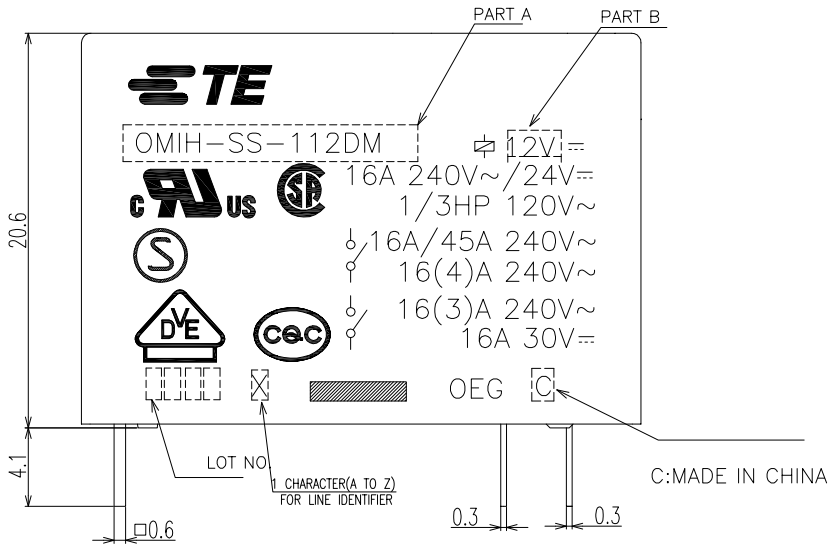
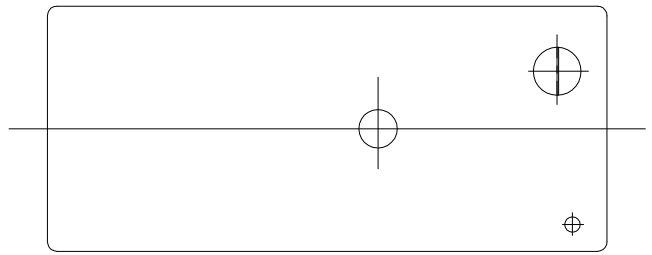

TE PART NO	DESCRIPTION	PART A	PART B	PACK. SPEC.	No.
B3	1-1721685-0	OMIH-SS-112LM,0000M	OMIH-SS-112LM	12V	107-84032 j
B3	1-1721685-2	OMIH-SS-112LM,01020	OMIH-SS-112LM	12V	107-84028 i
B2	1721685-7	OMIH-SS-112LM,00001	OMIH-SS-112LM	12V	107-79006 h
	9-1419121-1	OMIH-SS-148LM	OMIH-SS-148LM	48V	107-79006 k
	8-1419121-9	OMIH-SS-148DM	OMIH-SS-148DM	48V	107-79006 j
	8-1419121-8	OMIH-SS-124LM	OMIH-SS-124LM	24V	107-79006 i
	8-1419121-6	OMIH-SS-124DM	OMIH-SS-124DM	24V	107-79006 h
	8-1419121-4	OMIH-SS-118DM	OMIH-SS-118DM	18V	107-79006 g
	8-1419121-1	OMIH-SS-112LM	OMIH-SS-112LM	12V	107-79006 f
	7-1419121-9	OMIH-SS-112DM	OMIH-SS-112DM	12V	107-79006 e
	7-1419121-6	OMIH-SS-109LM	OMIH-SS-109LM	9V	107-79006 d
	2-1419145-0	OMIH-SS-109DM	OMIH-SS-109DM	9V	107-79006 c
	7-1419121-4	OMIH-SS-106LM	OMIH-SS-106LM	6V	107-79006 b
	7-1419121-3	OMIH-SS-105LM	OMIH-SS-105LM	5V	107-79006 a

RELAY TYPE

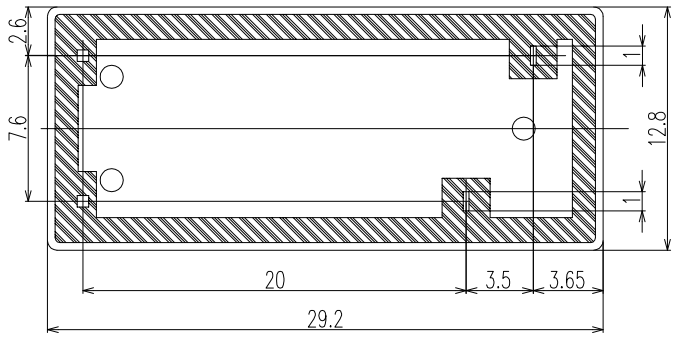

THIS DRAWING IS A CONTROLLED DOCUMENT.

DWN Davey Liu 25JUL2010	TE Connectivity OMIH CUSTOMER DRAWING
CHK Banghua Yu 26JUL2010	
APVD Sunny Zhang 27JUL2010	
PRODUCT SPEC	
APPLICATION SPEC	SIZE A3 CAGE CODE 00779 DRAWING NO C=7-1419121-9 RESTRICTED TO
MATERIAL	WEIGHT
TOLERANCES UNLESS OTHERWISE SPECIFIED:	SCALE 4:1 SHEET 1 OF 2 REV B3
0 PLC ±	
1 PLC ±	
2 PLC ±	
3 PLC ±	
4 PLC ±	
ANGLES ±	
FINISH	

THIS DRAWING IS UNPUBLISHED. RELEASED FOR PUBLICATION
 © COPYRIGHT - By - ALL RIGHTS RESERVED.

LOC	DIST	REVISIONS				
P	LTR	DESCRIPTION	ECO	DATE	DWN	APVD
-	-	SEE SHEET 1	-	-	-	-

NOTES:
 1. LOT NO. SYSTEM AS FOLLOWING:

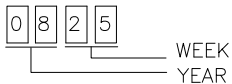

2. GENERAL TOLERANCE AS FOLLOWING:

TOLERANCE	
0~0.99mm	±0.1
1mm~2.99mm	±0.2
3mm MIN.	±0.3

3. TERMINAL DIMENSION IS NOT INCLUDING SOLDER TIP.

CONNECTION DIAGRAM
(BOTTOM VIEW)

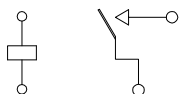

DRILLING DIAGRAM(2/1)
(BOTTOM VIEW)

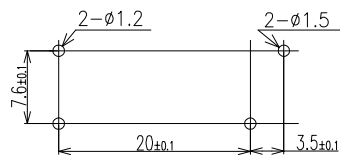

		UV RESIN	UV SEAL	16
		EPOXY RESIN	SEAL	15
UL94 V-0		PBT	CASE	14
CLASS E		UEW	MAGNETIC WIRE	13
UL94 V-0		PET	BASE	12
UL94 V-0		PBT	BOBBIN	11
	SOLDER DIP	CP WIRE	COIL TERMINAL	10
UL94 V-0		PPS	CARD	9
		Ag ALLOY	MOVABLE CONTACT	8
		Ag ALLOY	STATIONARY CONTACT	7
		Cu ALLOY	HINGE SPRING	6
	SOLDER DIP	Cu ALLOY	STATIONARY TERMINAL	5
	SOLDER DIP	Cu ALLOY	MOVABLE SPRING	4
		STEEL	CORE	3
		STEEL	ARMATURE	2
		STEEL	YOKE	1
INCOMBUSTIBILITY	TREATMENT	MATERIAL	DESCRIPTION	ITEM

THIS DRAWING IS A CONTROLLED DOCUMENT.

DWN	25JUL2010	 TE Connectivity	NAME OMIH CUSTOMER DRAWING		
CHK	26JUL2010				
APVD	27JUL2010				
PRODUCT SPEC					
APPLICATION SPEC		SIZE	CAGE CODE	DRAWING NO	RESTRICTED TO
WEIGHT	-	A3	00779	C=7-1419121-9	-
CUSTOMER DRAWING		SCALE	4:1	SHEET	2 OF 2
				REV	B3