

PRODUCT NUMBER	PITCH
YK881xx0x0J0G	12.70 mm

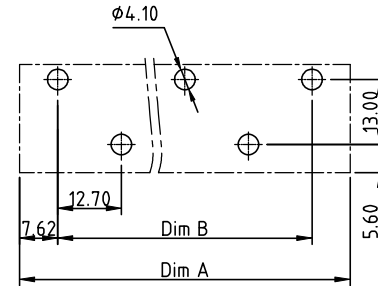

RECOMMENDED P.C.B LAYOUT  
TOP VIEW

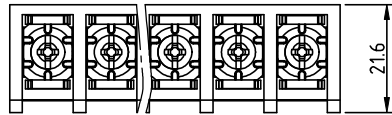
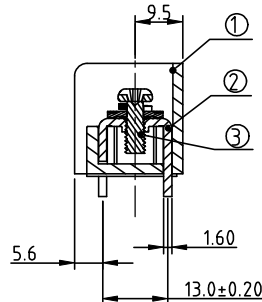
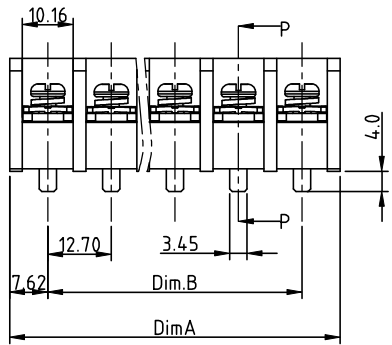
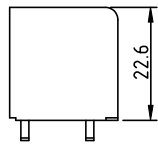

SECTION P-P

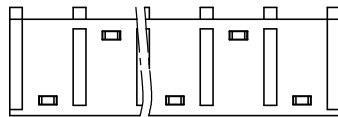

MATERIALS & ELECTRICAL  
 RATED VOLTAGE & CURRENT: 600 V, 45A  
 WITHSTAND VOLTAGE: AC 2500 V/Min  
 INSULATION RESISTANCE: 1000 MΩ OR MORE AT DC 500 V  
 OPERATING TEMPERATURE RANG: -40 °C ~ +115 °C  
 SCREW TORQUE VALUE: 16lb-in  
 WIRE RANGE: 18 - 8 AWG  
 1) HOUSING: THERMOPLASTICS, UL94-V0 BLACK  
 2) TERMINAL: BRASS, 1.6t  
 3) TERMINAL SCREWS WITH WASHER: STEEL, M4.0  
 APPROVAL: us

DIMENSION

Dim A	Nx12.7+2.54
Dim B	(N-1)x12.7

N=Number of poles

Tolerance Poles	Dim A	Dim B
3p/5P/7P	±0.40	±0.30
9p/11P/13P/15p	±0.50	±0.40
17p/19p	±0.60	±0.55

PART NO.: YK 881 xx 0 x x J0G

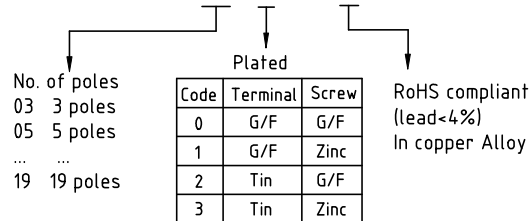

mat'l. code				surface ASME Y14.5 ✓		tolerance ASME Y14.5		projection		product family	
ltr ecn no dr date				tolerances unless otherwise specified		angles		MM		TERMINAL BLOCK	
				X±0.5		X.X±0.3		scale		title	
				X'±1*		X.XX±0.1				TERMINAL BLOCK	
				dr EVAN LU 061214		enr EVAN LU 061214		FCI		BARRIER TYPE, WITH FLANGE&COVER, ODD POLES	
				chr HANKE FENG 061214		appd EVAN LU 061214		scale		dwg no sheet 1 of 2 size	
										YK881xx0x0J0G A4	
sheet index				revision sheet		A 1				type CUSTOMER Drawing	

PRODUCT NUMBER	PITCH
YK881xx0x0JOG	12.70 mm

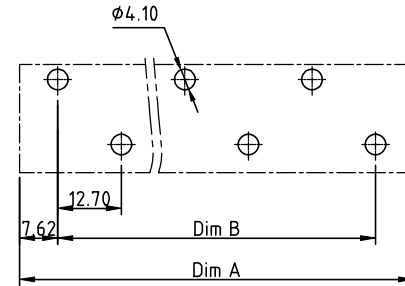
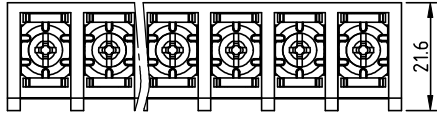

RECOMMENDED P.C.B LAYOUT  
TOP VIEW

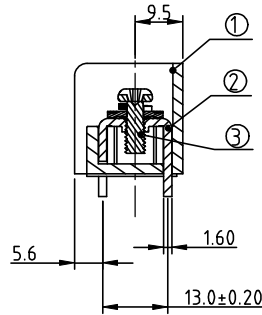
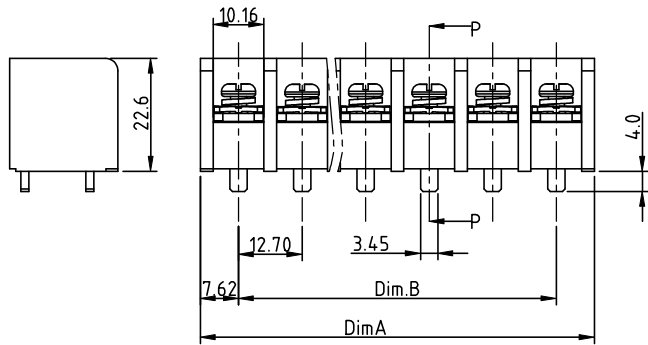

SECTION P-P

MATERIALS & ELECTRICAL  
 RATED VOLTAGE & CURRENT: 600 V, 45A  
 WITHSTAND VOLTAGE: AC 2500 V/Min  
 INSULATION RESISTANCE: 1000 M $\Omega$  OR MORE AT DC 500 V  
 OPERATING TEMPERATURE RANG: -40 °C ~ +115 °C  
 SCREW TORQUE VALUE: 16lb-in  
 WIRE RANGE: 18 - 8 AWG  
 1) HOUSING: THERMOPLASTICS, UL94-V0 BLACK  
 2) TERMINAL: BRASS, 1.6t  
 3) TERMINAL SCREWS WITH WASHER: STEEL, M4.0  
 APPROVAL: us

A

A

DIMENSION

Dim A	$N \times 12.7 + 2.54$
Dim B	$(N-1) \times 12.7$

N=Number of poles

Tolerance	Dim A	Dim B
Poles		
2p/4P/6P/8p	$\pm 0.40$	$\pm 0.30$
10p/12P/14P	$\pm 0.50$	$\pm 0.40$
16p/18p/20p	$\pm 0.60$	$\pm 0.55$

PART NO.: YK 881 xx 0 x x JOG

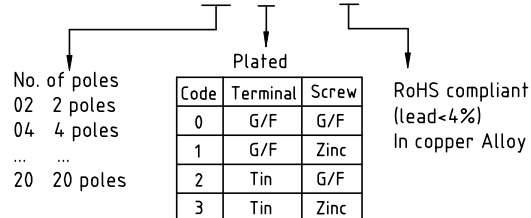

Code	Terminal	Screw
0	G/F	G/F
1	G/F	Zinc
2	Tin	G/F
3	Tin	Zinc

mat'l. code		surface	tolerance	projection	product family
		ASME Y14.5	ASME Y14.5		TERMINAL BLOCK
ltr	ecn no	dr	date	title	
				TERMINAL BLOCK	
				BARRIER TYPE, WITH FLANGE&COVER, EVEN POLES	
				scale	sheet 2 of 2 size
				YK881xx0x0JOG	
				CUSTOMER Drawing	
sheet	revision	A			
index	sheet	2			

B

B