

**NOTES:**

1. ONLY THE ITEMS WITH QUANTITIES SPECIFIED ON PARTS LIST ARE USED ON THIS APPLICATOR.

▲ USED IN PLACE OF ITEM 38 WHEN INSULATION CRIMP IS NOT USED.

▲ GUARD MUST BE IN PLACE WHEN OPERATING APPLICATOR IN AMP-O-LECTRIC PRESS.

▲ CUT TO LENGTH AT ASSY.

▲ SEE DWGS FOR COMPONENTS.

▲ QTY IN INCHES.

**KEY:**

■ RECOMMENDED SPARE PARTS.

▲ LUBRICATE DAILY USING NO 20 MACHINE OIL.

● GREASE LIGHTLY.

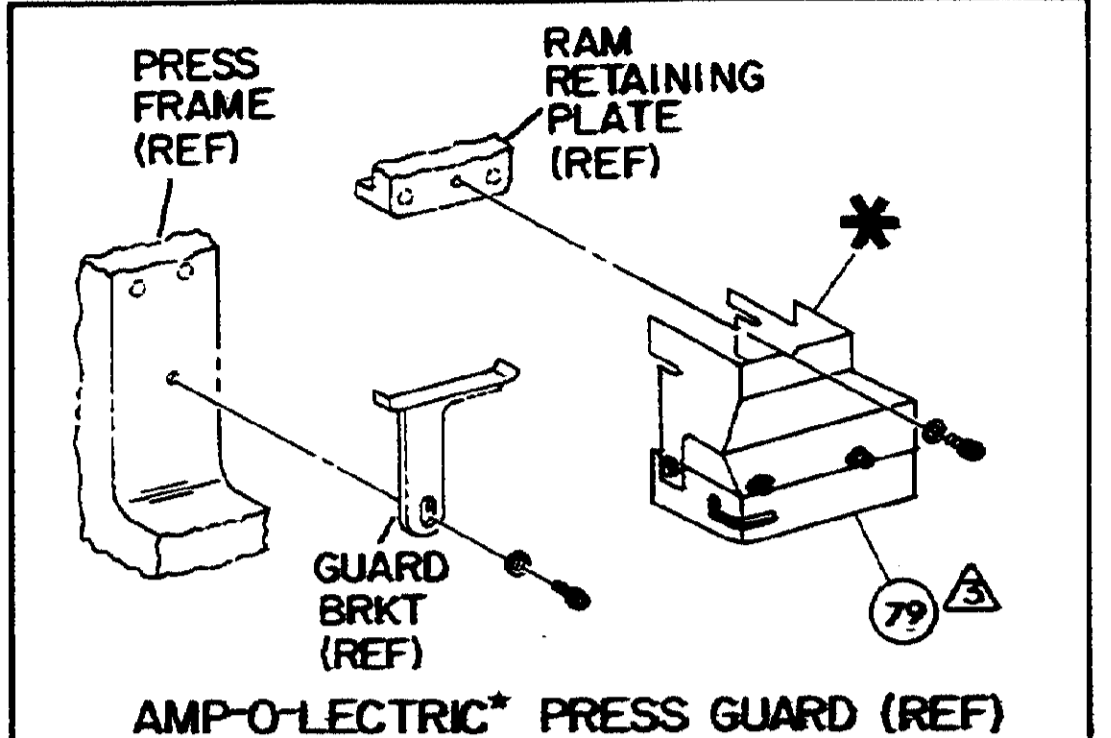
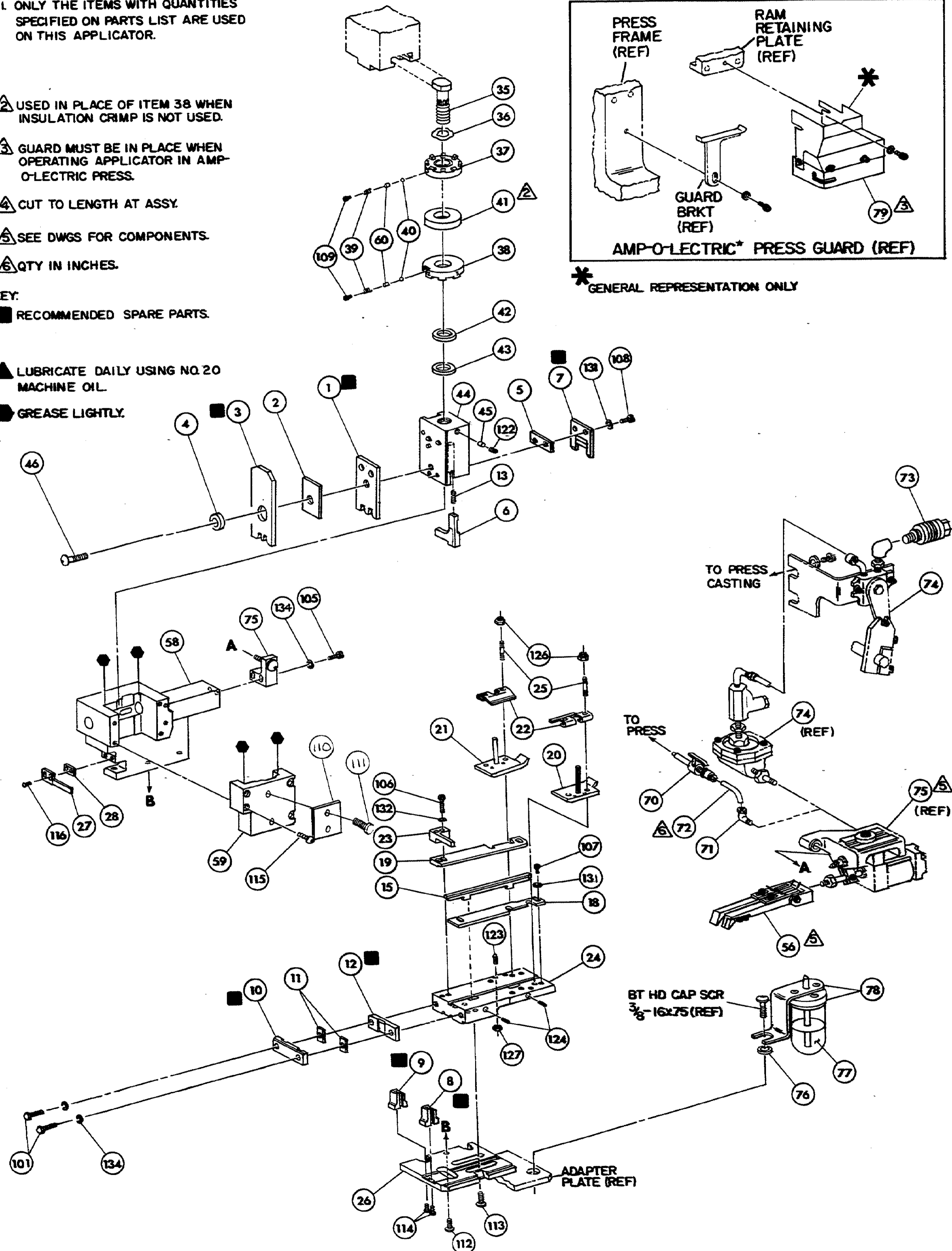

QTY	PART NO	DESCRIPTION	ITEM NO	QTY	PART NO	DESCRIPTION	ITEM NO	
				145	1	458268-1	CAP, RAM	59
				144	1	458267-1	HOUSING	58
				143				57
				142	1	460680-3	FEED FINGER ASSY	56
				141				55
				140				54
				139				53
				138				52
				137				51
				136				50
				135				49
	21024-5	WASHER, LOCK (NO 10) AIR FEED ASSY		134				48
4	21024-5	WASHER, LOCK (NO 10) SHEAR PLATES		133				47
				132	1	690636-2	BOLT, CRIMPER	46
	21024-4	WASHER, LOCK (NO 8) STRIP GUIDE		131	1	690191-1	PLUG, NYLON	45
6	21024-4	WASHER, LOCK (NO 8) SHEAR BLADE		130	1	458266-1	RAM	44
				129	1	690125-1	WASHER, LAMINATED	43
				128	1	690124-1	WASHER, RAM	42
4	21018-6	NUT, HEX MACH (8-32) DRAG ADJ SCREW		127			SPACER, DISC	41
4	21022-2	NUT, HEX SELF-LKG (8-32) DRAG STUD		126	2	23241-6	BALL, STEEL	40
2	1-21008-9	SCR, SKT SET (4-40 x .12) (LOC-WEL) DEP. HOLDER		125	2	690170-1	SPRING, COMPRESSION	39
2	3-21006-1	SCR, SKT SET (6-32 X .38) CTR STR GUIDE		124	1	690142-1	DISC, INSULATION	38
4	5-21061-5	SCR, SKT SET CONE POINT (8-32 X .88) DRAG		123	1	5-690141-6	DISC, WIRE	37
1	21009-2	SCR, SKT SET (1/4-20 X 25) (LOC-WEL) RAM		122	1	22480-5	WASHER, SPRING	36
				121	1	690212-1	POST, RAM	35
				120				34
				119				33
				118				32
				117				31
				116				30
2	2-21002-2	SCR, BTN HD SKT CAP (8-32 X .50) STRIPPER		115				29
4	3-21002-1	SCR, BTN HD SKT CAP (10-32 X 1.00) HSG CAP		114				28
2	22733-8	SCR, BTN HD SKT CAP (8-32 X .38) (LOC-WEL) ANVIL		113	1	3-690451-2	SPACER, STRIPPER	27
4	3-21002-3	SCR, BTN HD SKT CAP (1/4-20 X .50) STR GDE PL		112	1	458265-1	STRIPPER	26
3	2-22733-8	SCR, BTN HD SKT CAP (1/4-20 X .75) BASE PL		111	4	458263-1	PLATE, BASE	25
2	21017-2	SCR, DRIVE (#2 X .19) ID PLATE		110	1	22354-7	DRAG, STUD	24
1	461264-1	PLATE, IDENTIFICATION		109		458262-1	PLATE, STRIP GUIDE	23
2	23030-1	SCR, SKT HD CAP (6-32 X .25) (LOC-WEL) CP DISC		108	2	461389-1	PLATE, STRIP HOLD	22
2	2-21000-6	SCR, SKT HD CAP (8-32 X .38) SHEAR BLADE		107	1	458260-1	SPRING, DRAG	21
4	7-21000-4	SCR, SKT HD CAP (8-32 X .31) STRIP GUIDE		106	1	458259-1	DRAG, STOCK (LEFT)	20
2	3-21000-7	SCR, SKT HD CAP (10-32 X .75) AIR FEED ASSY		105	1	458258-5	DRAG, STOCK (RIGHT)	19
				104	1	458257-5	GUIDE, STRIP (LEFT)	18
				103			GUIDE, STRIP (RIGHT)	17
				102				16
2	3-21000-8	SCR, HEX HD CAP (10-32 X .88) SHEAR PLATE		101	1	1-458309-0	GUIDE, CENTER STRIP	15
1	455750-6	GUARD ASSY		79				14
REF	852931-2	OIL, LUBRICATING		78		23846-1	SPRING, HOLD DOWN	13
1	454406-1	SPACER, LUB BRACKET		77	1	458255-1	PLATE, REAR SHEAR	12
1	460277-3	AIR FEED ASSY		76			SPACER, SHEAR PLATE	11
	692655-1	AIR FEED VALVE ASSY		75	1	1-458254-1	PLATE, FRONT SHEAR	10
	24042-2	VALVE, SHUT OFF		74	1	6-238169-3	ANVIL, LEFT	9
15"	22620-1	TUBING, PLASTIC		73	1	6-238169-3	ANVIL, RIGHT	8
1	22294-6	ELBOW, PLASTIC TUBING		72	1	458253-5	BLADE, SLUG	7
		INSERT, COUPLING		71			HOLD DOWN, TERMINAL	6
				70	1	1-238075-1	SPACER, SHEAR BLADE	5
				69	1	238009-1	SPACER, TUBULAR	4
				68	1	1-458210-7	CRIMPER, INSULATION	3
				67	1	455888-6	SPACER, INSULATION	2
				66	1	3-458209-0	CRIMPER, WIRE	1

QTY		PART NO	DESCRIPTION	ITEM NO
1		694925-4	REEL BRKT CONVERSION ASSY	
2		690603-1	SPRING ASSIST	

CRIMPING DATA						APPLICATOR WILL APPLY	
PAD	CRIMP HEIGHT	WIRE SIZE	WIRE RANGE			42037-1	
LTR	LEFT	RIGHT	LEFT	RIGHT	LEFT	RIGHT	
A	.065	# 18	22-18				
B	.061	# 20	INSUL. RANGE				
C	.059	# 22	LEFT	.080-110			
D	NOT USED		RIGHT				
CRIMP	SIZE	TYPE	CRIMP	SIZE	TYPE	FEED	
WIRE	LEFT	RIGHT	INSUL	LEFT	RIGHT	LEFT	RIGHT
	.090	F		.140	F	.714	
PRESS REF: APPL INST A1 8046							
REMARKS: AMP-O-LECTRIC AIR FEED							

REMARKS	NO	REV
APPL USED ON MACHINE PART NO	MACH SERIAL NO	DISTRIBUTION
CUSTOMER NAME	APPL SERIAL NO	ORIGINAL
ADDRESS	PURCHASE ORDER	CUSTOMER COPY
CITY	ENG APP	FIELD ENG COPY

PIF	LTR	REVISION RECORD	APP DATE	PIF	LTR	REVISION RECORD	APP DATE

THIS INFORMATION IS CONFIDENTIAL AND IS DISCLOSED TO YOU ON CONDITION THAT NO FURTHER DISCLOSURE IS MADE BY YOU TO OTHER THAN AMP PERSONNEL WITHOUT WRITTEN AUTHORIZATION FROM AMP INCORPORATED, HARRISBURG, PA.